

TOWER NO - 7
24 TH FLOOR PLAN (PENTHOUSE LEVEL - 1)

TOWER NO - 8
24 TH FLOOR PLAN (PENTHOUSE LEVEL - 1)

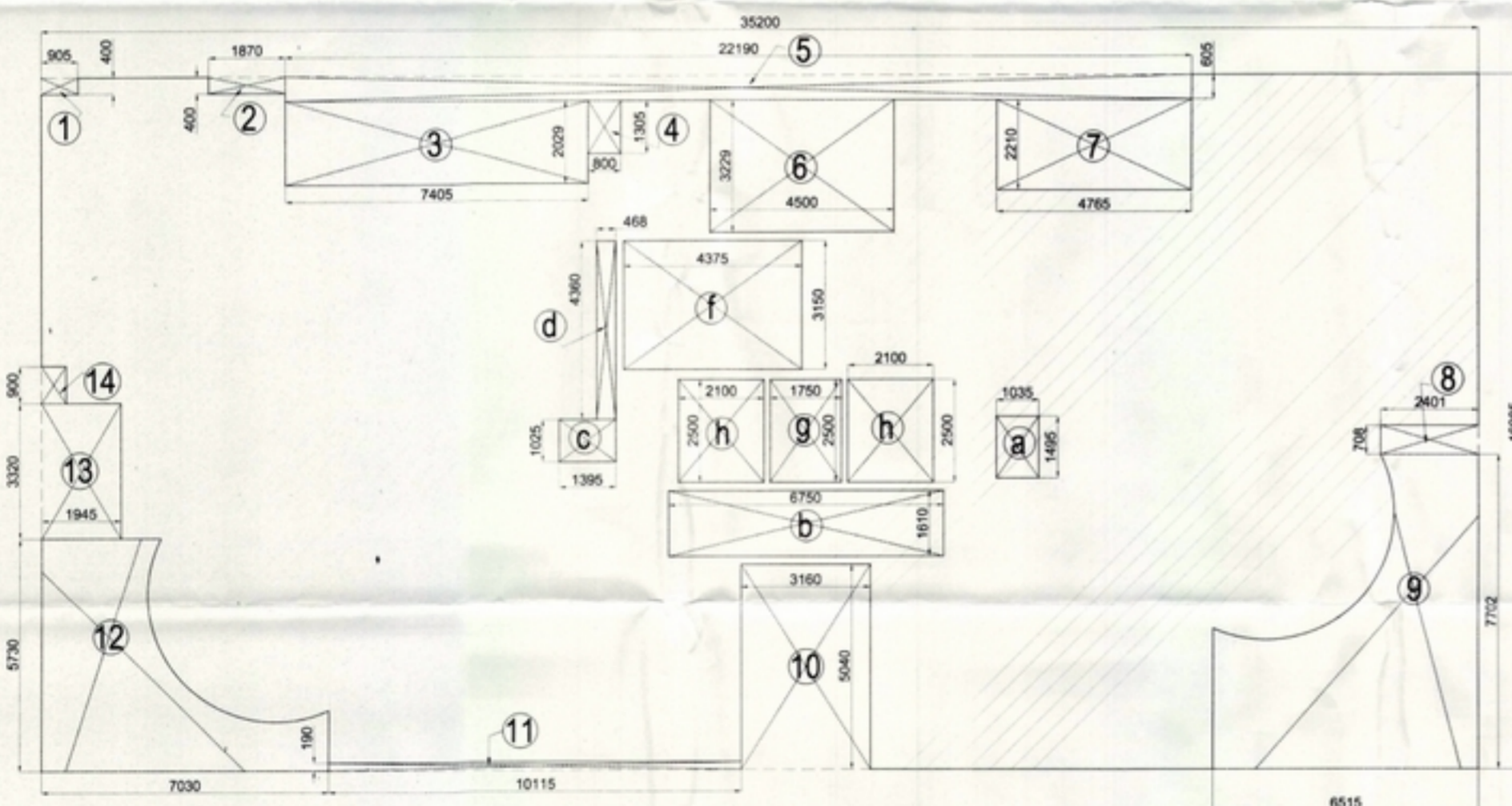

TOWER NO - 7 & 8
ENVELOPE OF 24TH FLOOR

DOOR SCHEDULE PENT HOUSE LEVEL-1						
SR NO	TYPE	SIZE	DESCRIPTION	LINTEL HT. (IN MM)	QUANTITY	LOCATION
1	D	1200 X 2400	SINGLE SWING	2400	04	MAIN DOOR
2	D1	800 X 2400	SINGLE SWING	2400	08	BEDROOM DOOR
3	D2	800 X 2400	SINGLE SWING	2400	02	TOILET, SERVANT ROOM, STORE
4	SD	3000 X 2400	SLIDING DOOR	2400	04	LIVING, BEDROOM
5	SD1	2700 X 2400	SLIDING DOOR	2400	04	LIVING, BEDROOM
6	SD2	2400 X 2400	SLIDING DOOR	2400	10	BEDROOM
7	SD3	2700 X 2400	SLIDING DOOR	2400	02	BEDROOM, FAMILY ROOM
8	SD4	1800 X 2400	SLIDING DOOR	2400	02	BEDROOM, KITCHEN
9	SD5	1800 X 2400	SLIDING DOOR	2400	08	KITCHEN, BEDROOM
10	SD6	1400 X 2400	SLIDING DOOR	2400	02	BEDROOM
11	SD7	1200 X 2400	SLIDING DOOR	2400	02	KITCHEN
12	SD8	1000 X 2400	SLIDING DOOR	2400	02	KITCHEN
13	FD	1000 X 2400	SINGLE SWING-FIRE DOOR	2400	04	STAIRCASE
14	OP	800 X 2400	OPENING	2400	04	KITCHEN
15	FD1	800 X 2400	DOUBLE SWING-FIRE DOOR	2400	08	ELEC. DUCT, FIRE DUCT
16	FD2	400 X 2400	SINGLE SWING-FIRE DOOR	2400	08	A.C. DUCT
17	DD	1800 X 2400	DOUBLE SWING	2400	04	PENTHOUSE STAIRCASE DOOR

WINDOW SCHEDULE PENT HOUSE LEVEL-1						
SR NO	TYPE	SIZE	DESCRIPTION	SILL LVL. (IN MM)	LINTEL HT. (IN MM)	LOCATION
1	W1	2700 X 1800	SLIDING WINDOW	900	2400	DOUBLE HEIGHT LIVING
2	W2	2400 X 1800	SLIDING WINDOW	900	2400	---
3	W3	2700 X 1800	SLIDING WINDOW	900	2400	DOUBLE HEIGHT LIVING
4	W4	1800 X 1800	SLIDING WINDOW	900	2400	LIVING, ENTRANCE LOBBY
5	W5A	1800 X 2300	SLIDING WINDOW	900	2400	LIVING, ENTRANCE LOBBY
6	W5B	1800 X 1800	SLIDING WINDOW	900	2400	BEDROOM, ENTRANCE LOBBY
7	W6A	1800 X 2300	SLIDING WINDOW	900	2400	BEDROOM, ENTRANCE LOBBY
8	W7	1200 X 1400	SLIDING WINDOW	900	2400	02 DINING
9	W8	800 X 1400	OPENABLE	1300	2400	04 STAIRCASE
10	W9	800 X 1200	OPENABLE	1200	2400	04 TOILET
11	W10	1500 X 7000	FIXED GLAZING	200	7000	12 PENT HOUSE STAIRCASE
12	W11	1500 @	---	---	---	08 TERRACE LVL, STAIRCASE
13	W12	2200 X 2400	SLIDING WINDOW	900	2400	02 LIFT SHAFT
14	02 10.8A	1200 X 1200	GRG JALI	1200	2400	08 TOILET DUCT / VOID
15	02 10.8	800 X 1200	GRG JALI	1200	2400	08 TOILET DUCT
16	02 10.12	1700 X 4000	GRG JALI	1200	4000	UTILITY
17	02 10.10	2200 X 8000	GRG JALI	1200	8000	TOILET DUCT / VOID
18	02 10.10	400 X 900	GRG JALI	1200	2400	A.C. DUCT
19	02 10.1F	800 X 4000	GRG JALI	1200	4000	TOILET DUCT
20	02 10.10	1000 X 4000	GRG JALI	1400	4000	UTILITY
21	02 10.14	375 X 375	GRG JALI	---	---	UTILITY
22	02 10.11	1200 X 4000	GRG JALI	1200	4000	TOILET DUCT
23	02 10.11	2200 X 7000	GRG JALI	1200	7000	TOILET DUCT
24	02 10.14	2700 X 800	GRG JALI	1200	2400	TOILET DUCT
25	02 10.14	800 X 800	GRG JALI	1200	2400	TOILET (SHOWER & 1ST FLOOR)
26	02 10.14	1500 @	GRG JALI	900	2400	VOID

24TH FLOOR AREA DETAIL (TOWER - 7)					
LEGEND	BREADTH (B)	LENGTH (L)	NOS.	AREA IN SQM	SPACE USAGE
[A]	35.200	X	16.985	X 1 = 597.872	---
				TOTAL = 597.872	--- (I)
DEDUCTIONS					
LEGEND	BREADTH (B)	LENGTH (L)	NOS.	AREA IN SQM	SPACE USAGE
1	0.905	X	0.400	X 1 = 0.362	OPEN AREA
2	1.870	X	0.400	X 1 = 0.748	
3	7.405	X	2.029	X 1 = 15.025	
4	0.800	X	1.305	X 1 = 1.044	
5	22.190	X	0.605	X 1 = 13.425	
6	4.500	X	3.229	X 1 = 14.531	
7	4.765	X	2.210	X 1 = 10.531	
8	2.401	X	0.708	X 1 = 1.700	
9	p. line area =		32.390	X 1 = 32.390	
10	3.160	X	5.040	X 1 = 15.926	
11	10.115	X	0.190	X 1 = 1.922	
12	p. line area =		22.490	X 1 = 22.490	
13	1.945	X	3.320	X 1 = 6.457	
14	0.600	X	0.900	X 1 = 0.540	
				TOTAL = 137.090	--- (II)
				NETT ENVELOPE ON FLOOR (I - II) = 460.782	--- (III)
SERVICES AREA					
LEGEND	BREADTH (B)	LENGTH (L)	NOS.	AREA IN SQM	SPACE USAGE
a	1.035	X	1.995	X 1 = 2.065	SER. SHAFT
b	6.750	X	1.610	X 1 = 10.868	LIFT LOBBY
c	1.395	X	1.025	X 1 = 1.430	SER. SHAFT
d	0.468	X	4.360	X 1 = 2.040	SER. SHAFT
f	4.375	X	3.150	X 2 = 27.563	FIRE STAIRCASE
				TOTAL SERVICE AREA = 43.965	--- (IV)
				NET FAR. ON FLOOR (III) - (IV) = 416.816	FAR
				TOWER (B) AREA IS SAME AS TOWER (7) AREA = 416.816	FAR

PROJECT	TITLE	JOB.NO.	DATE	DRN. BY	ARCHITECT'S SIGN.	OWNER'S SIGN	CONSULTANT
PROPOSED GROUP HOUSING BUILDING ON PLOT NO.GH-01/C, SEC - 168 NOIDA FOR.- SUNWORLD RESIDENCY PVT LTD.	REV. SUBMISSION DRAWING	1281	25 - 05 - 15	SANDEEP	<i>[Signature]</i>	<i>[Signature]</i>	R.N.Gupta & Associates Consulting Engineers, Architects & Valuers E - 1, Sector-55, Noida Phones - (+120) 4321556 email-info@rngcorp.com
	24TH FLOOR PLAN & AREA ENVELOPE CALCULATION (TOWER - 7 & 8)	DR.NO.	NORTH	CHKD. BY	<i>[Signature]</i> RAJIV GOEL CA/76/2361	For SUNWORLD RESIDENCY PVT. LTD. <i>[Signature]</i> Authorised Signatory	
		24		G.S.B.			