

18	REQUIRED PARKING FOR (2.75 F.A.R. + PURCHASABLE F.A.R. AREA + 5% GREEN BUILDING F.A.R. AREA) = 3,23,675.26 SQ.MT. @ 1 E.C.S. / 80 SQ.M. F.A.R. AREA = 3,23,675.26 / 80 = 4045.94 E.C.S. SAY AS = 4046 E.C.S.	4046 E.C.S.
19	PROPOSED PARKING FOR	4055 E.C.S.
A	OPEN PARKING AREA = 13,865.00 @ 20 SQ.MT. PER E.C.S. = 13,865.00 / 20 = 693.25 E.C.S. SAY 693.00 E.C.S.	
B	1st. BASEMENT PARKING AREA (PART - 01) = 47,187.14 @ 30 SQ.MT. PER E.C.S. 47,187.14 / 30 = 1572.905 E.C.S. SAY 1572.00 E.C.S.	
C	1st. BASEMENT PARKING AREA (PART - 02) = 26633.34 @ 30 SQ.MT. PER E.C.S. = 26797.84 / 30 = 893.261 E.C.S. SAY 893.00 E.C.S.	
D	2nd. BASEMENT PARKING AREA (PART - 02) = 26910.44 @ 30 SQ.MT. = 897.014 E.C.S. SAY AS 897 E.C.S.	
TOTAL PARKING (A+B+C+D) = 4055 E.C.S.		

Greater Noida Industrial Dev. Authority
APPROVED
 Valid up to Dated: 27/08/2017
 D.G.M. (Plng. & Arch.)
 Gen. Manager (Plng. & Arch.)
 Asstt. Arch. S.M. (Plng.)

Greater Noida Industrial Dev. Authority
REVISED
 Valid up to Dated: 27/08/2017
 Number: 15/17
 Asstt. Arch. S.M. (Plng.)

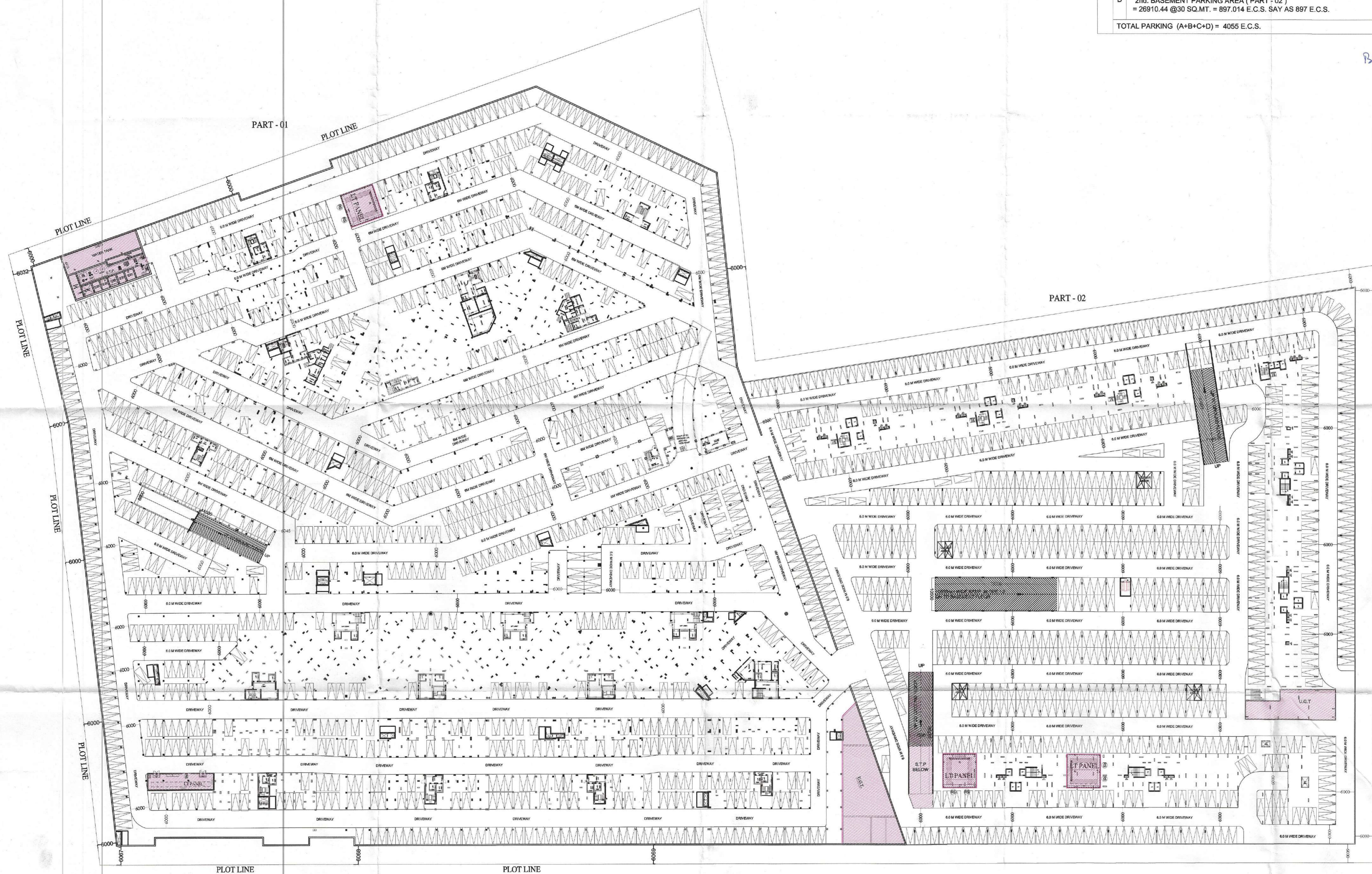

1st. BASEMENT PARKING PLAN

PROJECT :-
RESIDENTIAL COMPLEX AT GREATER NOIDA
 PLOT NO. GH-05 SECTOR - 16B

BUILDERS & PROMOTER :-
SHRI GROUP S.J.P. INFRACON LTD.,
 A-133, Sector 63, Noida

DRAWING TITLE :-
1st. BASEMENT PARKING PLAN

DRAWN BY :- CHECKED BY :- SCALE 1 : 600 DATED :-

For S.J.P. INFRACON LTD.
DARSHAN SINGH
 CA/89/12573

ARCHITECT'S SIGN.
 OWNER'S SIGN
 DRG.No. - 02