

PROJECT :-  
**PROPOSED  
 PRADHAN MANTRI AWAS YOJNA  
 HOUSING AT SECTOR-I, BASANTKUNJ,  
 LUCKNOW**

CLIENT :-  
**LUCKNOW DEVELOPMENT AUTHORITY**

BUILDING :-  
**RESIDENCE**

DRG. TITLE :-  
**PLUMBING DETAIL**

NOTES :-  
 1. ALL DIMENSIONS ARE IN MM.  
 2. WRITTEN DIMENSIONS IS TO BE FOLLOWED, DRAWING NOT BE SCALED.  
 3. THIS DRG. IS THE PROPERTY OF M/S ARCH DOT CREATION ARCHITECTS & INTERIOR DESIGNERS THIS DRAWING IS NOT TO BE REPRODUCED OR COPIED BEFORE THE PRIOR PERMISSION OF THE ARCHITECT.  
 4. ANY DISCREPANCY IN THE DRAWING IS TO BE BROUGHT TO THE NOTICE OF THE ARCHITECT BEFORE EXECUTION.

KEY PLAN :-

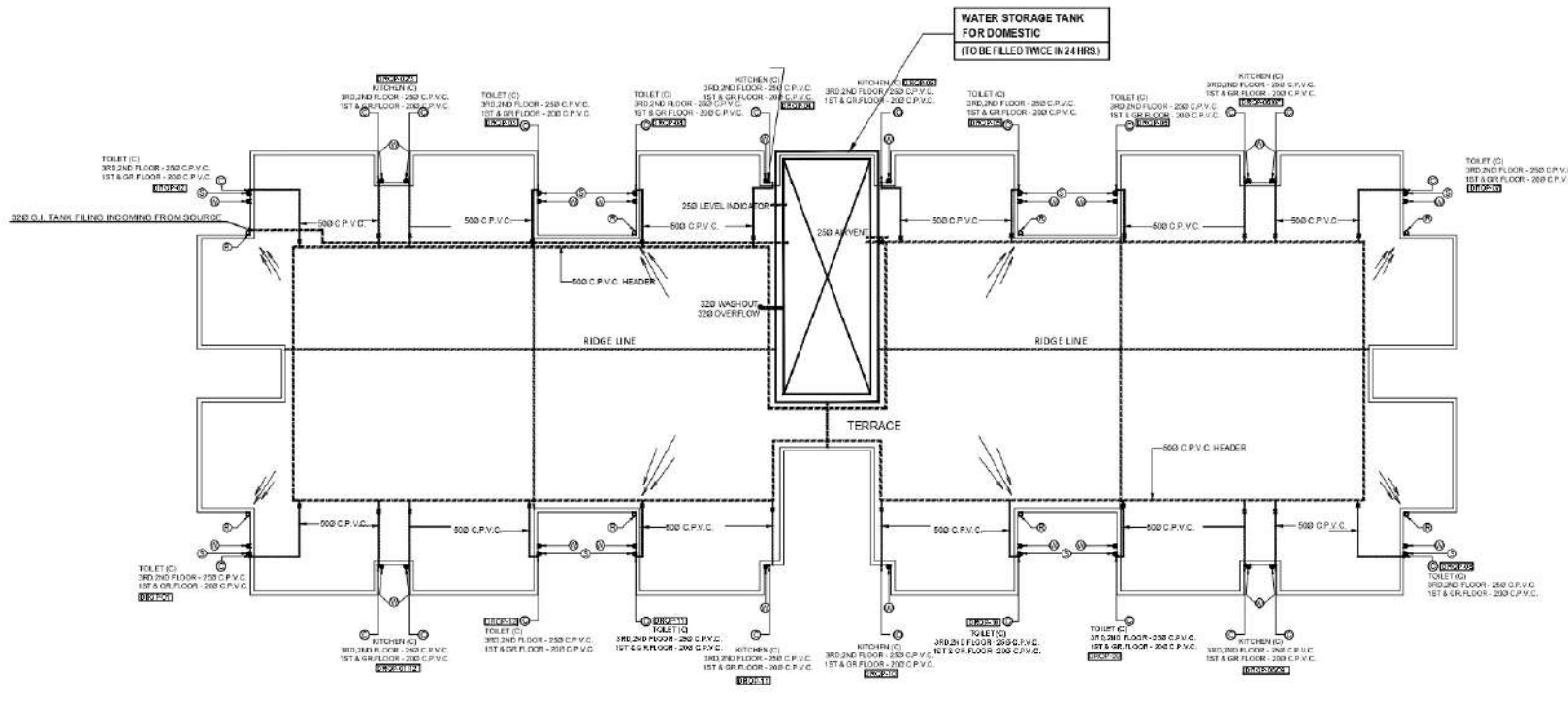

**LEGEND-(SANITARY)**

S.NO.	SYMBOL	DESCRIPTION
1.	(R)	110 OD PVC RAIN WATER PIPE
2.	(S)	110 OD SWR SOIL AND VENT PIPE
3.	(W)	110 OD SWR WASTE AND VENT PIPE
4.	(C)	WATER SUPPLY PIPE FROM TERRACE
5.	—	PIPE FOR COLD WATER SUPPLY
6.	M	BAL VALVE
7.	■	END PLUG
8.	250	PIPE DIA
9.	-----	RIDGE LINE
10.	↘	SLOPE DIRECTION

DATE :-  
**JULY-2019**

DRG. NO. :-  
**PL -02R**

DEALT BY :-  
**DEEPTI**

NORTH :-

CHECKED BY :-

ARCHITECT :-  
**SHUBHENDRA BAJPAI**

**NOTE : - THIS DRAWING HAS BEEN REVISED AS PER DISCUSSION WITH LUCKNOW DEVELOPMENT AUTHORITY.**

PROJECT :-  
**PROPOSED  
 PRADHAN MANTRI AWAS YOJNA  
 HOUSING AT SECTOR-I, BASANTKUNJ,  
 LUCKNOW**

CLIENT :-  
**LUCKNOW DEVELOPMENT AUTHORITY**

BUILDING :-  
**RESIDENCE**

DRG. TITLE :-  
**PLUMBING DETAIL**

NOTES :-  
 1. ALL DIMENSIONS ARE IN MM.  
 2. WRITTEN DIMENSIONS IS TO BE FOLLOWED,  
 DRAWING NOT BE SCALED.  
 3. THIS DRG. IS THE PROPERTY OF M/S ARCH DOT CREATION  
 ARCHITECTS & INTERIOR DESIGNERS THIS  
 DRAWING IS NOT TO BE REPRODUCED OR  
 COPIED BEFORE THE PRIOR PERMISSION OF  
 THE ARCHITECT.  
 4. ANY DISCREPANCY IN THE DRAWING IS TO  
 BE BROUGHT TO THE NOTICE OF THE ARCHITECT  
 BEFORE EXECUTION.

KEY PLAN :-

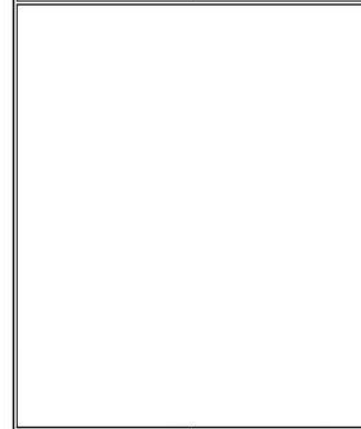

DATE :-  
**JULY-2019**

DRG. NO. :-  
**PL-01R**

DEALT BY :-  
**DEEPTI**

NORTH :-

CHECKED BY :-

ARCHITECT :-  
**SHUBHENDRA BAJPAI**

Handwritten signatures and stamps of the architect and client.

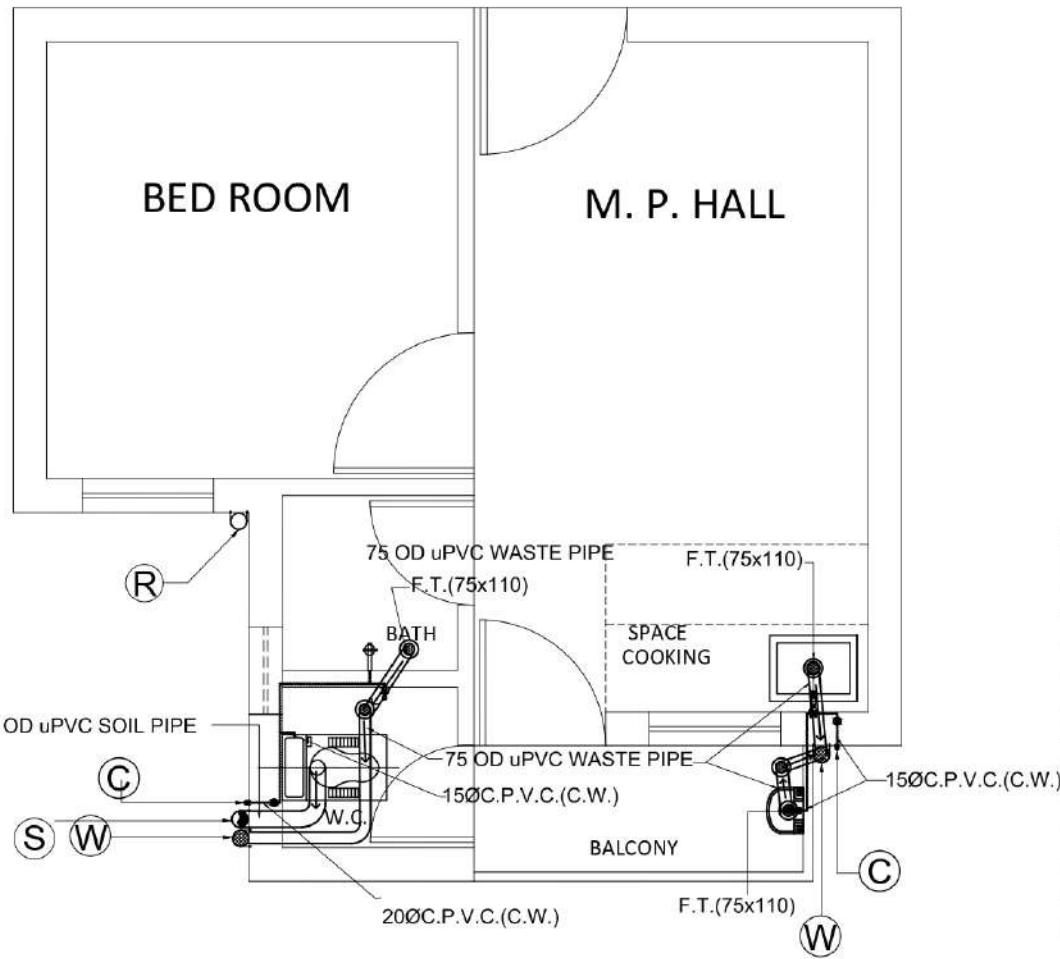

**LEGEND-(SANITARY)**

S.NO.	SYMBOL	DESCRIPTION
1.	(R)	110 OD PVC RAIN WATER PIPE
2.	(S)	110 OD SWR SOIL AND VENT PIPE
3.	(W)	110 OD SWR WASTE AND VENT PIPE
4.	(C)	WATER SUPPLY PIPE FROM TERRACE
5.	-----	PIPE FOR COLD WATER SUPPLY
6.	F.T.	FLOOR TRAP
7.	⊥	TAP/BIB COCK
8.	→	TAP FOR BATHING
9.	⊥	ORRISA PAN W.C.
10.	⊥	KITCHEN SINK
11.	⊙	BAL VALVE
12.	C.W	COLD WATER SUPPLY
13.	⊥	WASH BASIN

**BLOW-UP DETAIL**

NOTE : - THIS DRAWING HAS BEEN REVISED AS PER DISCUSSION WITH LUCKNOW DEVELOPMENT AUTHORITY.

WATER SUPPLY SYSTEM  
Over Head Tank 1000 kL- 3No.  
HDPE PIPE (110mm-200mm)

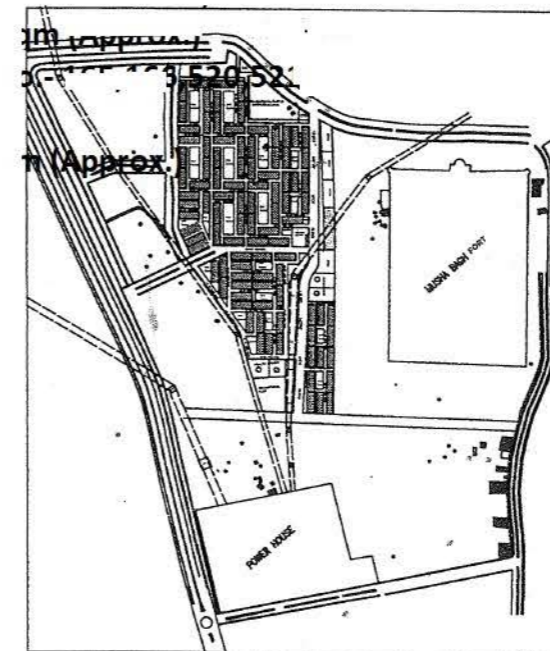

KEY PLAN

**PAKI LAYOUT PLAN OF  
SECTOR-I, BASANT KUNJ YOJNA,  
HARDOI ROAD SCHEME,  
LUCKNOW.**

**DETAIL OF PRADHANMANTRI AWAS:-**

TOTAL NO OF BLOCKS - 97  
UNITS IN ONE FLOOR - 12  
UNITS IN ONE BLOCK - 48  
TOTAL NO OF UNITS - 4656

**AREA STATEMENT:-**

S.N.	PARTICULARS	AREA (IN SQ.MT.)	% AGE
1.	TOTAL AREA OF SCHEME	144270.68 SQ.MT.	100 %
2.	AREA UNDER PMAY BLOCKS	49492.99 SQ.MT.	34.31%
3.	AREA UNDER OPEN SPACE (PARK+PARKING & GREEN)	21697.29 SQ.MT.	15.04%
4.	AREA UNDER COMMERCIAL	7788.71 SQ.MT.	05.40%
5.	AREA UNDER POLICE CHOWKI	740.65 SQ.MT.	00.51%
6.	AREA UNDER HEALTH CENTRE+N.H.	4822.17 SQ.MT.	03.34%
7.	AREA UNDER PRIMARY SCHOOL	1004.01 SQ.MT.	00.71%
8.	AREA UNDER EDUCATIONAL	9156.76 SQ.MT.	06.34%
9.	AREA UNDER GARBAGE COLLECTION	330.51 SQ.MT.	00.23%
10.	AREA UNDER ROADS	49237.59 SQ.MT.	34.12%

**NOTE:-**

1. THIS LAYOUT PLAN HAS BEEN PREPARED ON THE BASIS OF SURVEY PLAN GIVEN BY C.E. THROUGH LETTER NO.-213/C.E./2020-21 ON DATED 26-07-2021
2. NOC OF ASI IS REQUIRED FOR ANY CONSTRUCTION WITHIN 300MT. FROM THE BOUNDARY OF MOOSABAGH FORT MONUMENT.
3. THIS LAYOUT PLAN HAS BEEN PREPARED FOR SITE VERIFICATION ONLY.

**TENTATIVE**

DATE - 24 JULY, 2021

DRG. NO-

DEALT BY- MAMTA/TRACER

CHECKED BY- AMAR SINGH/D/M



**LUCKNOW DEVELOPMENT AUTHORITY**

  
 J.E.

  
 A.P.A.

आर्च कम् प्लानिंग अथिवा  
 नियोजा अनुमान

  
 E.E.

अधिशासी अभियन्ता  
 वि० प्रा० ल० ज०-

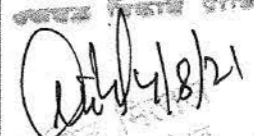
  
 C.T.P.

  
 SECY.  
 (पवन कुमार गंगवार)  
 सचिव

  
 V.C.