

PROJECT:-  
 PROPOSED RESIDENTIAL LAYOUT PLAN OF "ROYAL ESTATE"  
 FOR M/S SPIN & SCAM PVT. LTD. THROUGH ITS DIRECTOR  
 MR. SHYAM AGARWAL S/D MR. HETESH KUMAR AGARWAL  
 R/O SHRI DURGHA INDUSTRIES COMPOUND, AZIZGANJ, SHIVAJINAGAR  
 AND SON'S DEVELOPERS ITS PARTNER  
 AMAN AGARWAL, PRANAV KUMAR AGARWAL, RAJESH KUMAR AGARWAL,  
 HETESH KUMAR AGARWAL, YOGESH KUMAR AGARWAL,  
 AJAY AGARWAL & SHYAM AGARWAL  
 R/O SHRI DURGHA INDUSTRIES COMPOUND, AZIZGANJ, SHIVAJINAGAR  
 SITE AT GATA NO. 495, 496 & 723 OF VILLAGE- AZIZGANJ  
 GATA NO. 3071, 4, 5, 6, 7, 8 & 9 OF VILLAGE- NAWADA INDEPUR,  
 TANGSI- SADAK, DIST. SHIVAJINAGAR

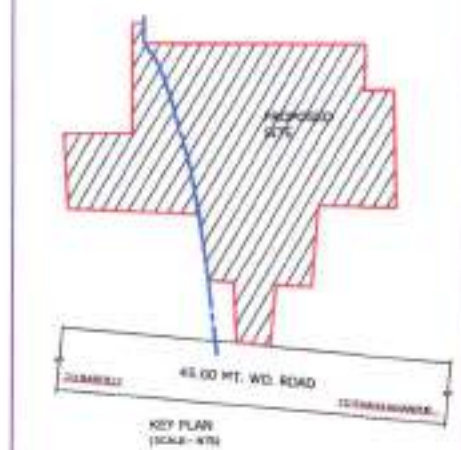
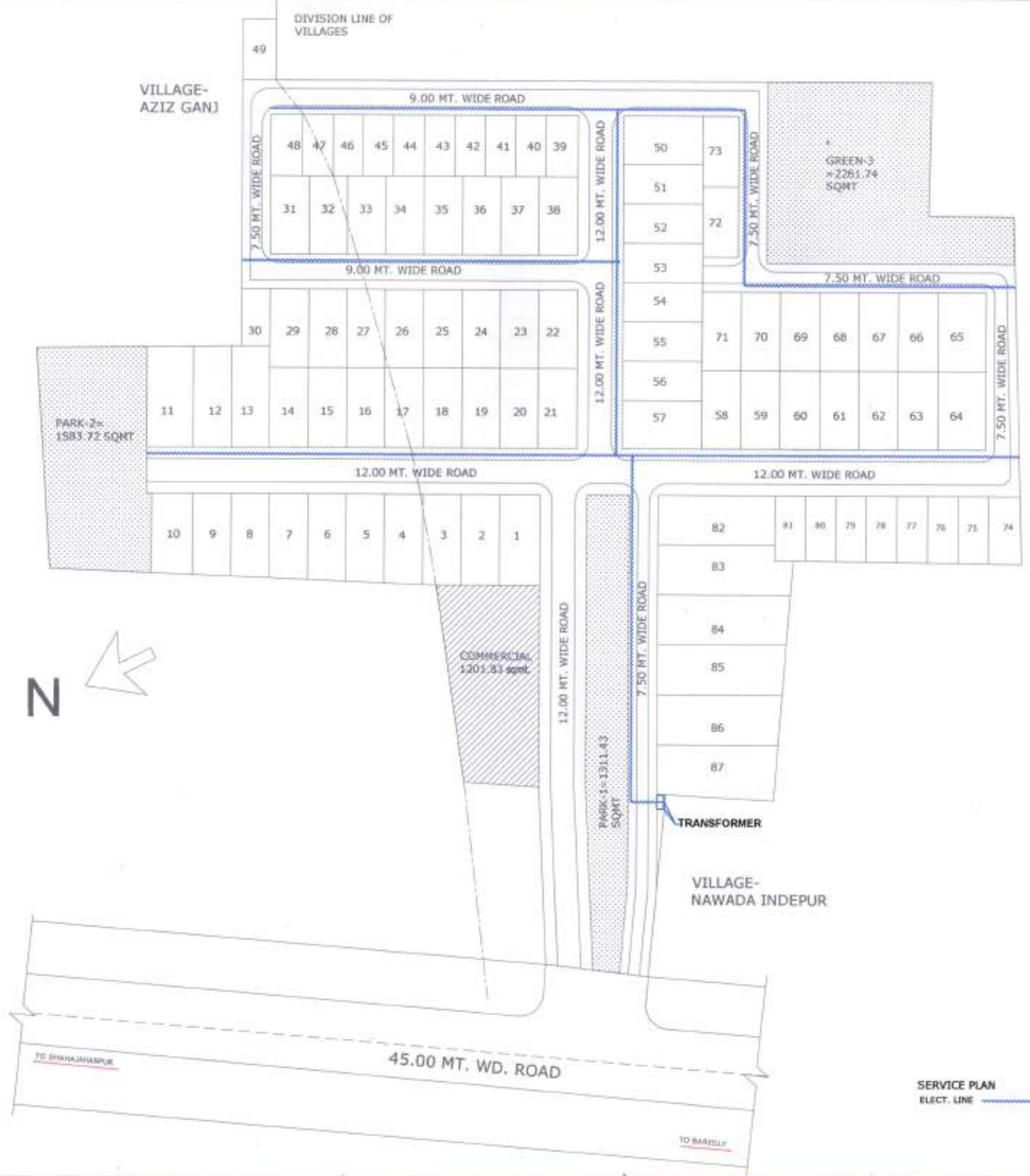

LEGEND		SERVICES	
NOTED		ELECT. LINE	
AREA			
SHEET TITLE	SHEET NO.	SCALE	
SERVICES DRAWING	18	AS SHOWN	
OWNER'S SIGN			

ARCHITECT

ANUPAM ARCHITECTS & INTERIOR DESIGNERS  
 INTERIOR DESIGNERS

B-340, RAJENDRA NAGAR, BAREILLY,  
 Mob. 9997054783

PROJECT:-  
 PROPOSED RESIDENTIAL LAYOUT PLAN OF "ROYAL ESTATE"  
 FOR M/S SPAN & SONS PVT. LTD. THROUGH ITS DIRECTOR  
 MR. SHYAM AGARWAL, S/O MR. HETESH KUMAR AGARWAL  
 R/O 8482 GURGA INDUSTRIAL COMPOUND, AZADNAGAR, SHRIHAMPUR  
 AND SONS DEVELOPING ITS PLOTS  
 ANAND AGARWAL, PRANAV KUMAR AGARWAL, RAJEEV KUMAR AGARWAL,  
 HETESH KUMAR AGARWAL, TOUSHI KUMAR AGARWAL,  
 RAJY AGARWAL & SHYAM AGARWAL,  
 S/O SHRI GURGA INDUSTRIAL COMPOUND, AZADNAGAR, SHRIHAMPUR  
 NCT OF DELHI AT GATE NO. 499, 498 & 712 OF VILLAGE- AZADNAGAR  
 DATA NO. 571, 4, 5, 6, 7, 8 & 9 OF VILLAGE- NAWADA INDEPUR,  
 TEHSIL- SADAR, DIST. SHAHANPUR

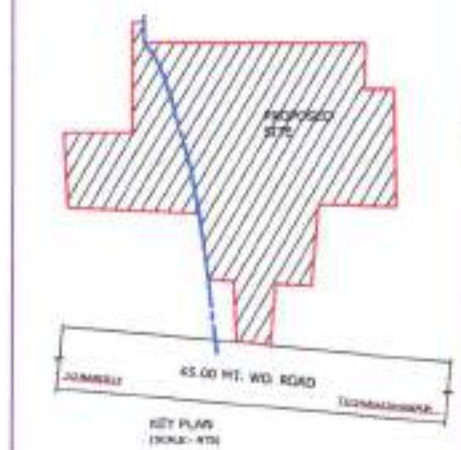
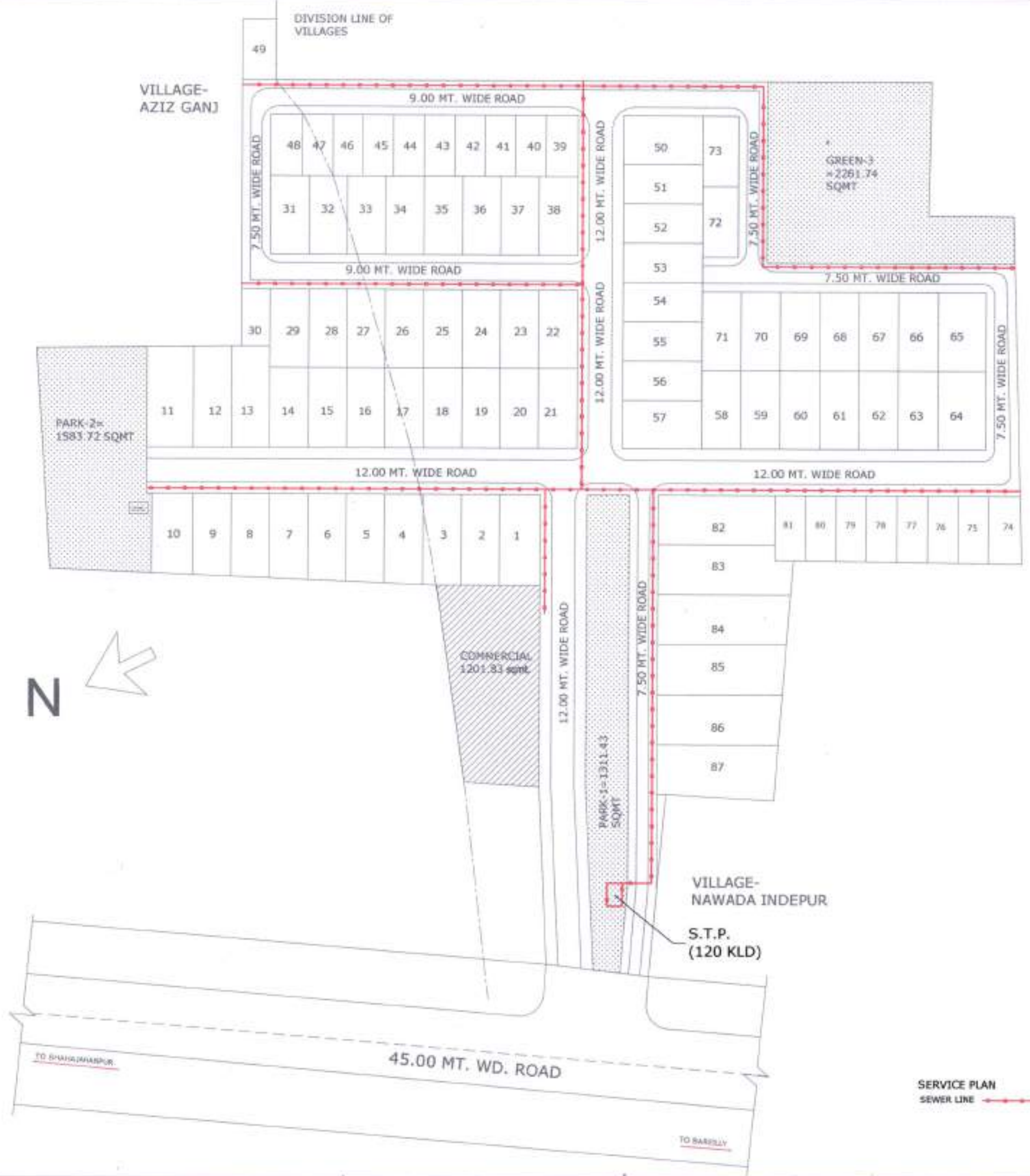

LEGEND

PLATTED	[Red hatched pattern]	SERVICES	[Red dashed line]
GREEN	[Green hatched pattern]	SEWER LINE	[Red dashed line]

SHEET TITLE	SHEET NO.	SCALE
SERVICE DRAWING	1D	AS SHOWN

OWNER'S SIGN

ARCHITECT

ARCHITECTS & INTERIOR DESIGNERS

ANUPAM ARCHITECTS & INTERIOR DESIGNERS

INTERIOR DESIGNERS

B-340, RAJENDRA NAGAR, BAREILLY.  
 Mob. 9897054783



