

BASEMENT- 01 FLOOR PLAN

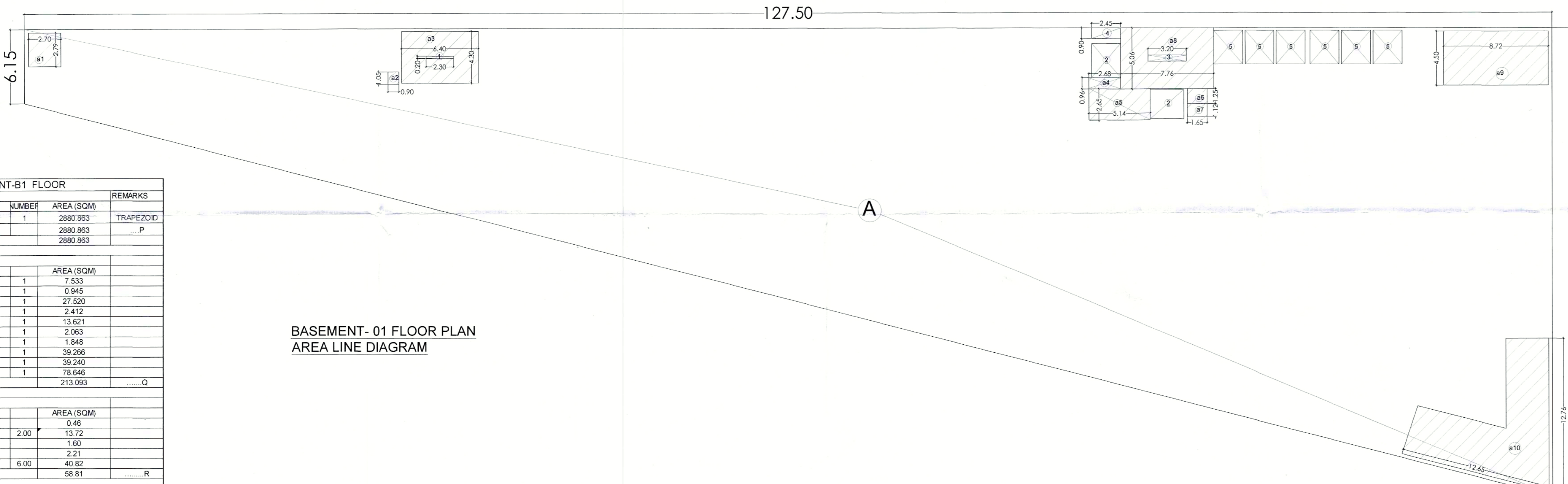

BASEMENT- 01 FLOOR PLAN  
AREA LINE DIAGRAM

BASEMENT-B1 FLOOR					REMARKS
S.NO	L	W	NUMBER	AREA (SQM)	
A	127.5	22.595	1	2880.863	TRAPEZOID
TOTAL				2880.863	.....P
TOTAL ENVELOPE AREA = P					2880.863
DEDUCTION (15% SERVICE AREA)					AREA (SQM)
a1	L	W	NUMBER	AREA (SQM)	
a1	2.7	2.78	1	7.533	
a2	0.9	1.05	1	0.945	
a3	6.40	4.30	1	27.520	
a4	2.68	0.9	1	2.412	
a5	5.14	2.65	1	13.621	
a6	1.65	1.25	1	2.063	
a7	1.65	1.12	1	1.848	
a8	7.760	5.06	1	39.266	
a9	8.720	4.50	1	39.240	
a10	PLINE		1	78.646	
TOTAL SERVICE AREA = Q				213.093	.....Q
CUTOUT					AREA (SQM)
1	L	W	NUMBER	AREA (SQM)	
1	2.30	0.20		0.46	
2	2.45	2.80	2.00	13.72	
3	3.20	0.50		1.60	
4	2.45	0.90		2.21	
5	2.43	2.80	6.00	40.82	
TOTAL CUTOUT = R				58.81	.....R
ECS AREA (T) = (P-Q-R)				2608.960	.....T
NON FAR (T)				2608.960	
F.A.R	NON F.A.R	15% SERVICE AREA			
0	2608.960	213.093			

**GENERAL NOTES :**

1. THIS DRAWING IS THE PROPERTY OF WESTRIVER PVT. LTD. ITS COPYRIGHT IS RESERVED WITH THEM. IT MUST NOT BE REPRODUCED OR REPRODUCED IN ANY FORM WITHOUT THE WRITTEN CONSENT OF MS MONTEVISTA PRIVATE LIMITED.
2. ALL DIMENSIONS ARE IN METERS UNLESS OTHERWISE NOTED. DO NOT SCALE DRAWING. ONLY WRITTEN DIMENSIONS ARE TO BE FOLLOWED.
3. ALL THE AREAS INDICATED ARE IN SQ.M.
4. COLUMNS ARE ONLY INDICATIVE AND WILL BE AS PER RELEVANT STRUCTURAL DRAWINGS.
5. THE UNITS MARKED HEREIN ARE SMALLER SIZE UNITS. THE ALLOTTEES HEREIN UNDERSTANDS THAT THESE SMALLER SIZE UNITS MAY BE LEASED OUT ALONG WITH ONE OR MORE SUCH UNITS INCLUDING THEIR ACCESS, CORRIDORS HEREIN AFTER REFERRED TO AS "COMPOSITE UNIT" FOR THE PURPOSE OF LEASING PROPERTIES AND RETAILERS/TENANTS REQUIREMENTS. THE COMPOSITE UNIT OR ONE OR MORE SMALL SIZE UNITS SHALL HAVE ADEQUATE ACCESS/USAGE OF OCCUPANT/TENANT. THE ALLOTTEES OF THE SAID SMALL SIZE UNITS AGREE AND ACKNOWLEDGE THE SAME.
6. THE DEVELOPER/LESSEE CAN CHANGE PARTITION/SIZES OF SHOPS/UNITS AS PER REQUIREMENT WITHIN THE SANCTIONED BUILDING ENVELOPE.
7. THE UNITS SHALL BE USED FOR COMMERCIAL ACTIVITIES SUCH AS SHOPPING MALLS, SHOWROOMS, RETAIL OUTLETS, HOTELS, RESTAURANTS, OFFICES AND SUCH OTHER COMMERCIAL USES AS PER CHOICE OF LESSEE/SUBLESSEE/TENANT.
8. THIS BUILDING PLAN IS ANTICIPATED TO BE REVISED UPON AVAILMENT OF ADDITIONAL FAR. ADDITIONAL FLOORS MAY BE ADDED SUBJECT TO STRUCTURAL, VETTING, FLOOR SIZE AND DESIGN MAY BE CHANGED OR SERVICE FLOOR MAY BE CONVERTED INTO USABLE FLOOR OF FULL HEIGHT. THE ALLOTTEES HAVE CLEARLY UNDERSTOOD AND SHALL HAVE NO OBJECTION TO THE SAME.

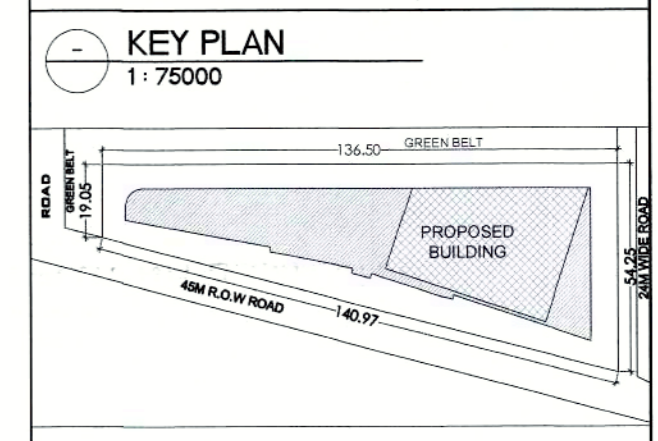

**OWNER:**  
WESTRIVER PVT. LTD.

**LOCATION :**  
PLOT NO. COMM-01  
SECTOR-93B, NOIDA, U.P.

**PROJECT:**  
PROPOSED SUBMISSION DRAWING  
FOR COMMERCIAL BUILDING  
'DABNAC PLACE' AT SECTOR '93B,  
NOIDA, U.P.

**TITLE:** BASEMENT-01 PLAN  
**DATE:** 10-01-2024  
**SCALE:** 1:200

**ARCHITECTS:** NIDA CONSULTANTS  
architects, engineers, interior, project management  
V-297/8, SECTOR-12, NOIDA, PIN-201307  
nidaconsultants.noida@gmail.com

**OWNER'S SIGN:** \_\_\_\_\_  
**ARCHITECT SIGN:** \_\_\_\_\_  
ARCHITECT: ANOOR MOHAMMED ALI KHAN  
REG. NO. CA/2019/7214F  
V-297/8, SECTOR-12, NOIDA,  
PIN-201307  
PH. 9893882786, 0120-2530491

**DRG NO.:** SD-05

सत्यापित प्रति  
रजिस्ट्रार एवं नियोजन विभाग  
नोएडा

For Westriver  
Authorised Signatory