

Sl. No.	Particulars	Unit	Quantity	Rate	Amount
1	Excavation for 1.5m dia pit	m ³	100	100	10000
2	Concrete for 1.5m dia pit	m ³	100	100	10000
3	Gravel for 1.5m dia pit	m ³	100	100	10000
4	Sand for 1.5m dia pit	m ³	100	100	10000
5	Labour charges				
6	Material charges				
7	Overhead charges				
8	Profit				
9	Total				

Sl. No.	Particulars	Quantity	Unit	Remarks
1
2
3
4
5
6
7
8
9
10
11
12
13
14
15
16
17
18
19
20
21
22
23
24
25
26
27
28
29
30
31
32
33
34
35
36
37
38
39
40
41
42
43
44
45
46
47
48
49
50
51
52
53
54
55
56
57
58
59
60
61
62
63
64
65
66
67
68
69
70
71
72
73
74
75
76
77
78
79
80
81
82
83
84
85
86
87
88
89
90
91
92
93
94
95
96
97
98
99
100

Sl. No.	Particulars	Quantity	Unit	Remarks
1
2
3
4
5
6
7
8
9
10
11
12
13
14
15
16
17
18
19
20
21
22
23
24
25
26
27
28
29
30
31
32
33
34
35
36
37
38
39
40
41
42
43
44
45
46
47
48
49
50
51
52
53
54
55
56
57
58
59
60
61
62
63
64
65
66
67
68
69
70
71
72
73
74
75
76
77
78
79
80
81
82
83
84
85
86
87
88
89
90
91
92
93
94
95
96
97
98
99
100

Sl. No.	Particulars	Quantity	Unit	Remarks
1
2
3
4
5
6
7
8
9
10
11
12
13
14
15
16
17
18
19
20
21
22
23
24
25
26
27
28
29
30
31
32
33
34
35
36
37
38
39
40
41
42
43
44
45
46
47
48
49
50
51
52
53
54
55
56
57
58
59
60
61
62
63
64
65
66
67
68
69
70
71
72
73
74
75
76
77
78
79
80
81
82
83
84
85
86
87
88
89
90
91
92
93
94
95
96
97
98
99
100

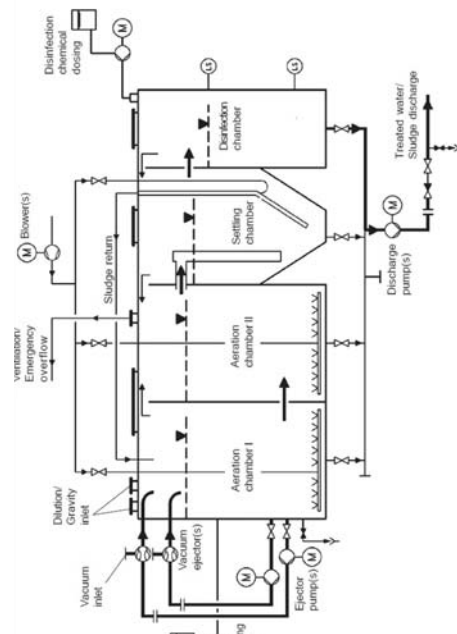

Sewage Treatment Plant detail
Capacity - 30 KLD

PROJECT OWNER/CLIENT: SHRI NITIN SINGHAL S/O RAM TEERTH SINGHAL, NIBARKA GUPTA W/O SAURABH GUPTA, SAURABH KOCHAR S/O I. K. KOCHAR & ASHOK KUMAR RAJAK S/O DEENDAYAL RAJAK
PROJECT ADDRESS: SMARDHA, KANPUR-GWALIOR BYPASS, JHANSI
DATE: 20/06/2024
SCALE: 1:1000
PROJECT NO.: 20/06/2024
DESIGNER: SHRI NITIN SINGHAL S/O RAM TEERTH SINGHAL, NIBARKA GUPTA W/O SAURABH GUPTA, SAURABH KOCHAR S/O I. K. KOCHAR & ASHOK KUMAR RAJAK S/O DEENDAYAL RAJAK
CLIENT'S SIGNATURE: [Signature]
DESIGNER'S SIGNATURE: [Signature]
DATE: 20/06/2024
PROJECT NO.: 20/06/2024
SCALE: 1:1000
PROJECT ADDRESS: SMARDHA, KANPUR-GWALIOR BYPASS, JHANSI
DESIGNER'S CONTACT: 9896071000, 9896071001
DESIGNER'S ADDRESS: [Address]
DESIGNER'S PHONE: 9896071000, 9896071001
DESIGNER'S EMAIL: [Email]
DESIGNER'S WEBSITE: [Website]
DESIGNER'S SOCIAL MEDIA: [Social Media]
DESIGNER'S OFFICE: [Office]
DESIGNER'S CONTACT: 9896071000, 9896071001
DESIGNER'S ADDRESS: [Address]
DESIGNER'S PHONE: 9896071000, 9896071001
DESIGNER'S EMAIL: [Email]
DESIGNER'S WEBSITE: [Website]
DESIGNER'S SOCIAL MEDIA: [Social Media]
DESIGNER'S OFFICE: [Office]

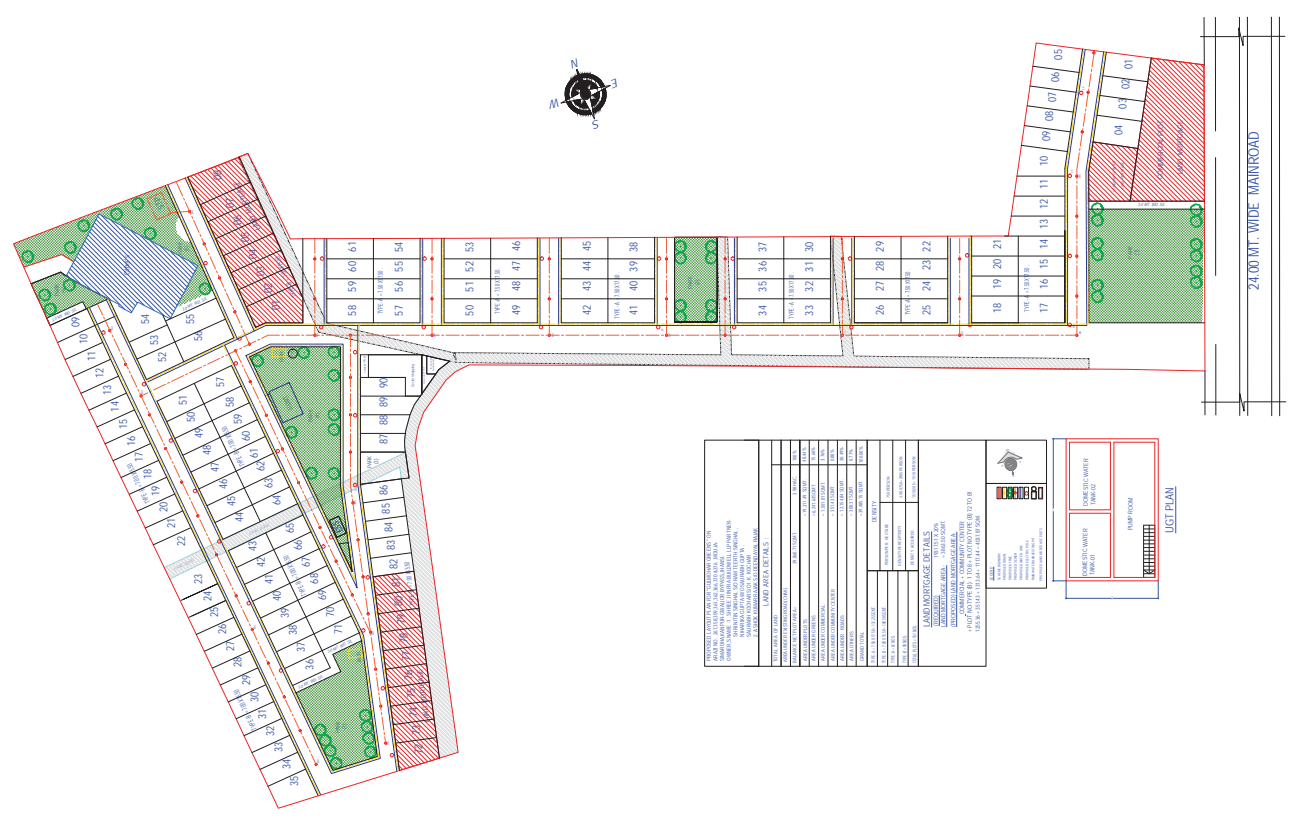

PROJECT INFORMATION

PROJECT NAME: GULMOHAR GREENS
 PROJECT ADDRESS: ONARAZI NO. 267, 358, 359, 361, 362, 366, 370 & 376, MOUJA - SMARDHA, KANPUR-GWALIOR BYPASS, JHANSI
 PROJECT OWNER: SHREE JI INFRA BUILDWELL LLP
 PROJECT PARTNER: SHRI NITIN SINGHAL S/O RAM TEERTH SINGHAL, NIHARIKA GUPTA W/O SAURABH GUPTA, SAURABH KOCHAR S/O I. K. KOCHAR
 PROJECT NO: 267, 358, 359, 361, 362, 366, 370 & 376

CLIENT INFORMATION

CLIENT NAME: ASHOK KUMAR RAJAK S/O DEENDAYAL RAJAK
 CLIENT ADDRESS: [Address details]
 CLIENT CONTACT: [Contact details]

DESIGNER INFORMATION

DESIGNER NAME: [Designer Name]
 DESIGNER ADDRESS: [Designer Address]
 DESIGNER CONTACT: [Designer Contact]

APPROVALS

APPROVED BY: [Signature]
 DATE: [Date]

LEGEND

RESIDENTIAL PLOTS
 ROADS
 GREEN SPACES
 OPEN SPACES

PROJECT NAME: GULMOHAR GREENS	PROJECT ADDRESS: ONARAZI NO. 267, 358, 359, 361, 362, 366, 370 & 376, MOUJA - SMARDHA, KANPUR-GWALIOR BYPASS, JHANSI
PROJECT OWNER: SHREE JI INFRA BUILDWELL LLP	PROJECT PARTNER: SHRI NITIN SINGHAL S/O RAM TEERTH SINGHAL, NIHARIKA GUPTA W/O SAURABH GUPTA, SAURABH KOCHAR S/O I. K. KOCHAR
PROJECT NO: 267, 358, 359, 361, 362, 366, 370 & 376	
DATE: 20.12.2023	SCALE: 1:1000
SHEET NO: 01 OF 02	