

NOTES:
 • All Dimensions Are In MM
 • The contractor shall verify all dimensions, details, specifications & site conditions & shall report any error, omission and/or anomaly to the architect before commencement of work.
 • For construction purposes, the dimensions shall not be measured directly on the drawings. The drawings shall not be used for construction until they are issued for construction.
 • This drawing is the property of the architect and it should not be copied and reproduced for any other purpose for which was issued, without the prior permission of the architect.

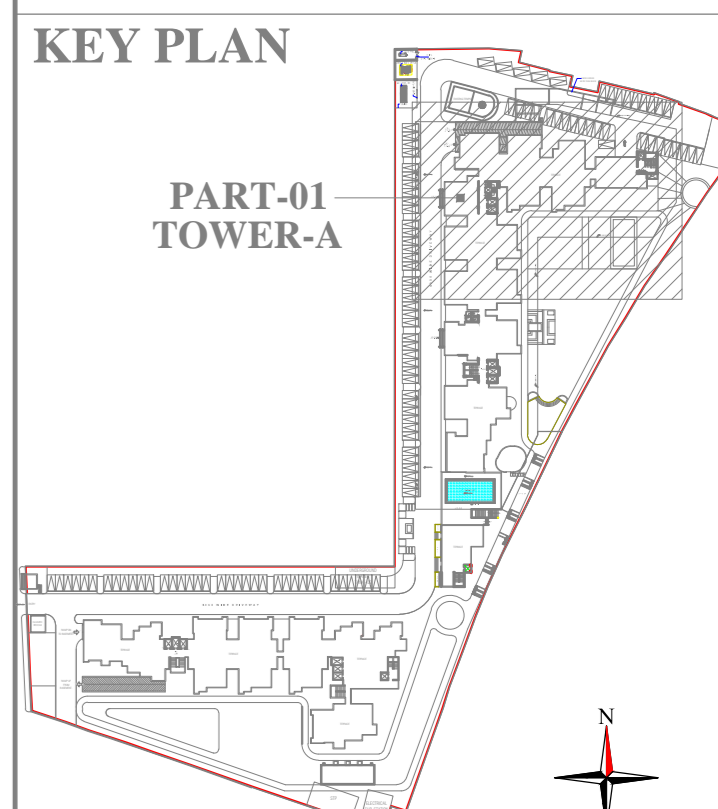

DOOR WINDOW SCHEDULE

TYPE	SIZE	LEVEL	LEVEL	REMARK
CD1	2000 x 2100 (100)	00.000	2000	
CD2	1800 x 2100 (100)	00.000	2000	
CD3	2000 x 2400 (100)	00.000	2000	
CD4	1800 x 2400 (100)	00.000	2000	
CD5	1800 x 2100 (100)	00.000	2000	
CD6	2000 x 1800 (100)	00.000	2000	
CD7	1800 x 1800 (100)	00.000	2000	
CD8	1800 x 1500 (100)	00.000	2000	
CD9	1800 x 1200 (100)	00.000	2000	
CD10	1800 x 900 (100)	00.000	2000	
CD11	1800 x 600 (100)	00.000	2000	
CD12	1800 x 300 (100)	00.000	2000	
CD13	1800 x 150 (100)	00.000	2000	
CD14	1800 x 75 (100)	00.000	2000	
CD15	1800 x 37.5 (100)	00.000	2000	
CD16	1800 x 18.75 (100)	00.000	2000	
CD17	1800 x 9.375 (100)	00.000	2000	
CD18	1800 x 4.6875 (100)	00.000	2000	
CD19	1800 x 2.34375 (100)	00.000	2000	
CD20	1800 x 1.171875 (100)	00.000	2000	
CD21	1800 x 0.5859375 (100)	00.000	2000	
CD22	1800 x 0.29296875 (100)	00.000	2000	
CD23	1800 x 0.146484375 (100)	00.000	2000	
CD24	1800 x 0.0732421875 (100)	00.000	2000	
CD25	1800 x 0.03662109375 (100)	00.000	2000	
CD26	1800 x 0.018310546875 (100)	00.000	2000	
CD27	1800 x 0.0091552734375 (100)	00.000	2000	
CD28	1800 x 0.00457763671875 (100)	00.000	2000	
CD29	1800 x 0.002288818359375 (100)	00.000	2000	
CD30	1800 x 0.0011444091796875 (100)	00.000	2000	
CD31	1800 x 0.00057220458984375 (100)	00.000	2000	
CD32	1800 x 0.000286102294921875 (100)	00.000	2000	
CD33	1800 x 0.0001430511474609375 (100)	00.000	2000	
CD34	1800 x 0.00007152557373046875 (100)	00.000	2000	
CD35	1800 x 0.000035762786865234375 (100)	00.000	2000	
CD36	1800 x 0.0000178813934326171875 (100)	00.000	2000	
CD37	1800 x 0.000008940696716130859375 (100)	00.000	2000	
CD38	1800 x 0.0000044703483580654296875 (100)	00.000	2000	
CD39	1800 x 0.00000223517417903271484375 (100)	00.000	2000	
CD40	1800 x 0.00000111758708951636372421875 (100)	00.000	2000	
CD41	1800 x 0.000000558793544758181812109375 (100)	00.000	2000	
CD42	1800 x 0.0000002793967723790909060546875 (100)	00.000	2000	
CD43	1800 x 0.00000013969838618954545302734375 (100)	00.000	2000	
CD44	1800 x 0.000000069849193094772726513671875 (100)	00.000	2000	
CD45	1800 x 0.0000000349245965473863632578125 (100)	00.000	2000	
CD46	1800 x 0.00000001746229827369318162890625 (100)	00.000	2000	
CD47	1800 x 0.0000000087311491368465908144519453125 (100)	00.000	2000	
CD48	1800 x 0.00000000436557456742272790722578125 (100)	00.000	2000	
CD49	1800 x 0.000000002182787283711363853514140625 (100)	00.000	2000	
CD50	1800 x 0.0000000010913936418556819267570703125 (100)	00.000	2000	

No. DESCRIPTION DATE

GREEN CONSULTANTS

LANDSCAPE ARCHITECT

STRUCTURE CONSULTANTS
T C STRUCTURAL CONSULTANTS PVT. LTD.
 R-307 DDA COMPLEX, 24 VEER SAVARKAR BLOCK
 CHANDAPUR, VIKAS MARKET DELHI-110
 PH: 2200601

SERVICE CONSULTANTS
 Stellar India
 MEP consultant
 G-202 Plot No. 619, Sector-142, Vihar Road
 New Delhi - 110025
 Email: stellarindia@gmail.com, info@stellarindia.org
 T E L : +919960282826

CLIENT
SHREE TRIDEVDHAM GROUP OF COMPANIES

PROJECT
TRIDEV INDRAPRASTHA HOUSING AT SARNATH

DRAWING TITLE
SEWERAGE AND DRAINAGE LAYOUT PART-01 (TOWER-A)

ARCHITECTS
PNG DESIGN CONSULTING LLP.
 Unit No. 619, 6th Floor, Tower-B
 Advant-Navis Business Park
 Plot No-7, Sec-142, Noida, 201301

Scale: 1:100 @ A0 NORTH
 Date: 26.07.2017
 Drawn: Ranvir
 Checked: Manoj
 DRG. NO. TIH/TA-A-100/01 Rev. NO. R0

SHAFT SCHEDULE TOWER-A

SHAFT NO.	SHAFT DESCRIPTION	SHAFT SIZE & LOCATION			
		STILT FLOOR LVL.	1ST FLOOR LVL.	TYP. 2ND-13TH FLOOR LVL.	TERRACE FLOOR LVL.
H1	BASEMENT ZONE-2 VENTILATION & PLUMBING PLANT ROOM FRESH AIR	2785 X 1270	-	-	-
H2	BASEMENT ZONE-2 VENTILATION & LT PANEL ROOM- EXHAUST AIR	2065 X 1070	-	-	-
H3	BASEMENT ZONE-1 VENTILATION- FRESH AIR	2025 X 1500	-	-	-
H4	BASEMENT ZONE-1 VENTILATION- FRESH AIR	970 X 2025	-	-	-
H5	BASEMENT ZONE-1 VENTILATION- EXHAUST AIR	970 X 2025	-	-	-
H6	BASEMENT ZONE-1 VENTILATION- FRESH AIR	785 X 1500	-	-	-
H7	BI-LIFT LOBBY-1 PRESSURIZATION	1100 X 600	-	-	-
H8	BI-LIFT LOBBY-2 PRESSURIZATION	620 X 1070	-	-	-
H9	FIRE & PLUMBING PUMP ROOM VENTILATION EXHAUST AIR	500 X 800	-	-	-
E1	MV SHAFT	1200 X 600	1200 X 600	1200 X 600	1200 X 600
E2	LV SHAFT	600 X 400	600 X 400	600 X 400	600 X 400
E3	MV SHAFT	500 X 340	500 X 485	500 X 485	500 X 485
E4	LV SHAFT	400 X 340	400 X 485	400 X 485	400 X 485
F1	FRIC SHAFT	300 X 300	300 X 600	-	-
F2	FRIC SHAFT	300 X 300	300 X 300	300 X 300	300 X 300
F3	FRIC SHAFT	600 X 300	600 X 300	600 X 300	600 X 300
F4	FRIC SHAFT	600 X 300	300 X 600	300 X 600	300 X 600

FLOOR LEVELS

FLOOR TYPE	FLOOR IN LVL.	TOP OF SLAB LVL.	ASBUT DET.
1	BASEMENT	-900	-800
2	STILT FLOOR	+900	+850
3	1st	+1200	+1150
4	2nd	+1500	+1450
5	3rd	+1800	+1750
6	4th	+2100	+2050
7	5th	+2400	+2350
8	6th	+2700	+2650
9	7th	+3000	+2950
10	8th	+3300	+3250
11	9th	+3600	+3550
12	10th	+3900	+3850
13	11th	+4200	+4150
14	12th	+4500	+4450
15	13th	+4800	+4750
16	TERRACE	+4800	+4250

DWG. NO. SCHEDULE

TAG	DESCRIPTION	REFR. DWG. NO.
ST-01	STAIRCASE	TIH/TA/A-401
ST-02	STAIRCASE	TIH/TA/A-402
ST-03	STAIRCASE	TIH/TA/A-403
RAMP-01	RAMP	TIH/TA/A-401
UGTANK	UNDER GROUND WATER TANK	TIH/TA/A-406
STP	SEWAGE TREATMENT PLANT	TIH/TA/A-407
LB-01	LIFT LOBBY	TIH/TA/A-401
LB-02	LIFT LOBBY	TIH/TA/A-402
LB-03	LIFT LOBBY	TIH/TA/A-403

