

S.T.P.
Cap.760 KLD
AREA -750 Sqm.

| LEGEND : | |
|----------|-------------------------------------|
| S. No. | SYMBOL DESCRIPTION |
| 1. | DOMESTIC WATER SUPPLY LINE |
| 2. | RISING MAINS FROM TUBE WELL |
| 3. | MUNICIPAL WATER SUPPLY PIPE LINE |
| 4. | EXISTING TUBE WELL |
| 5. | MASONRY CHAMBER FOR ISOLATING VALVE |
| 6. | |
| 7. | |
| 8. | |

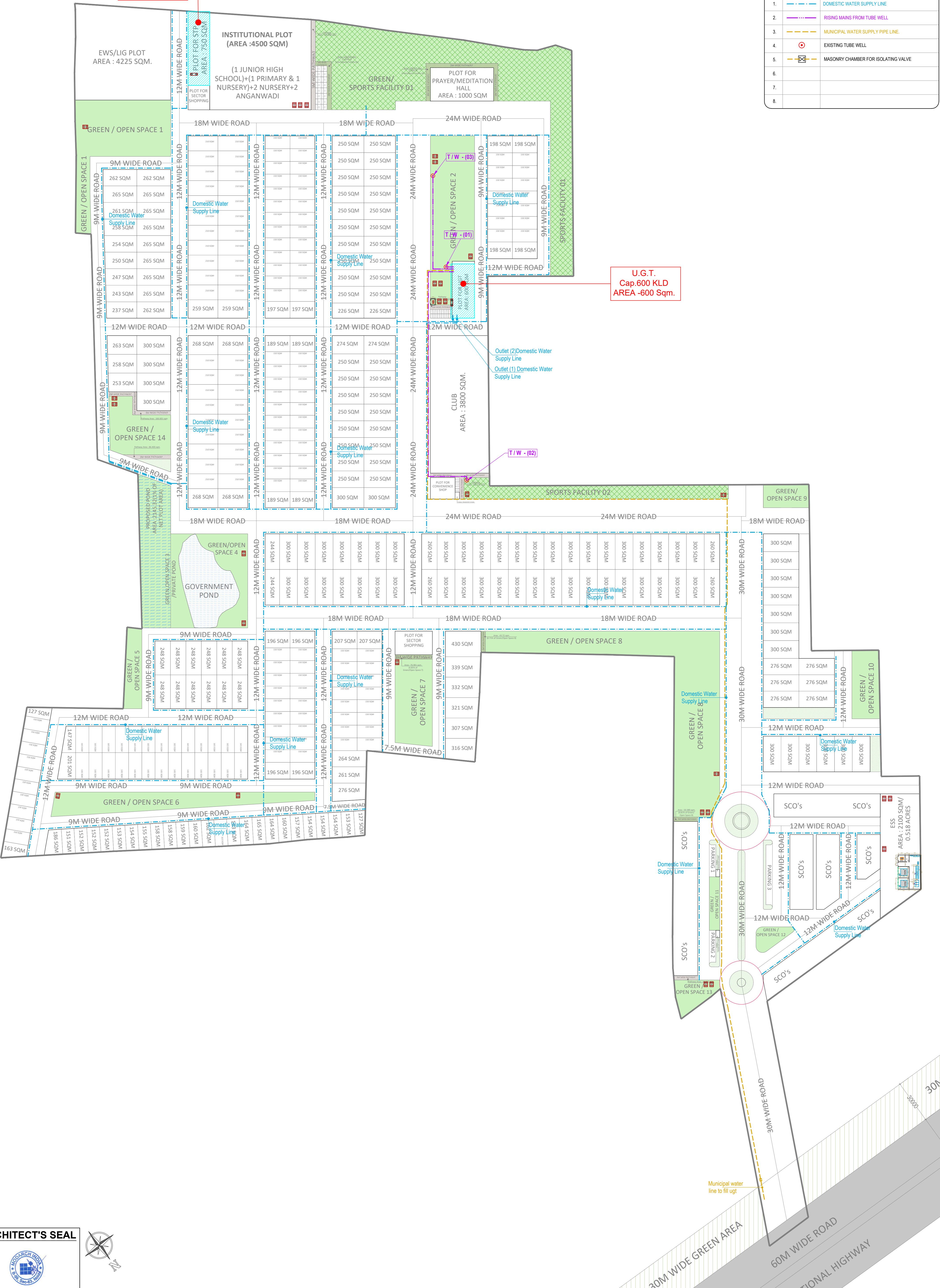

U.G.T.
Cap.600 KLD
AREA -600 Sqm.

ARCHITECT'S SEAL

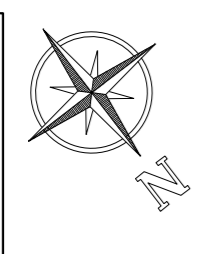

Project :
PROPOSED INTEGRATED TOWNSHIP
"GULMOHAR PARK"
AT NH24 MORADABAD (U.P.)

Title :
LAYOUT PLAN

Subtitle :
EXTERNAL DOMESTIC WATER SUPPLY SYSTEM

Drawing Released For :

- APPROVAL
- ADVANCE COPY
- SUBMISSION
- CONSTRUCTION

Drng. No :
MORADABAD/ ES-03

Date :
29 February 2024

Scale :
1:1200

Drawn By :
Amit kumar

Design By :

Ckd By :
Anand Havelia

Architects :
Modarchindia
Architects interior designers & planners
Studio: 1st floor, B-49, sector-63, Noida -201301, U.P.
Phone: 01120 4206253.
email: amitgargal@hotmail.com, website: www.modarch.in

Services Consultant :
Consummate Engineering Services (P) Ltd.
Noida Office : B - 67, Sector - 67, Noida - 201 301
Tel : (0120) 2303500 (24 Lines)
Lko. Office : R 006, Rohtas Plumeria, Gomti Nagar, Lucknow
e mail : mail@cespl.in, website : www.cespl.in

S.T.P.
Cap.760 KLD
AREA -750 Sqm.

| S. No. | SYMBOL | DESCRIPTION |
|--------|--------|--|
| 1. | | RECYCLED (HORTICULTURE) WATER SUPPLY PIPE LINE |
| 2. | | GARDEN HYDRANT |
| 3. | | |
| 4. | | |
| 5. | | |

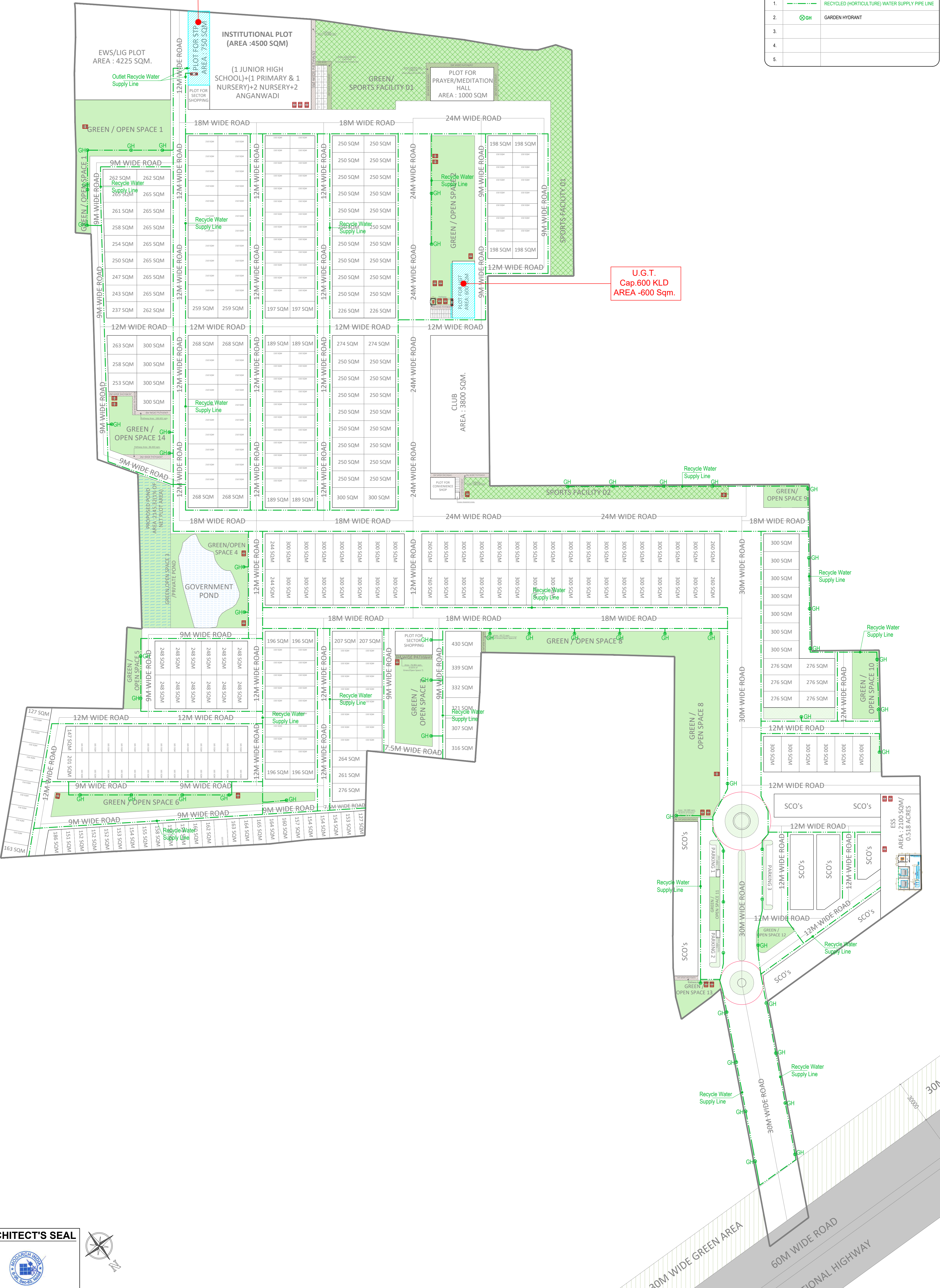

U.G.T.
Cap.600 KLD
AREA -600 Sqm.

ARCHITECT'S SEAL

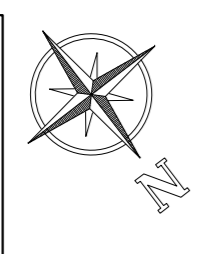

Project :
**PROPOSED INTEGRATED TOWNSHIP
"GULMOHAR PARK"
AT NH24 MORADABAD (U.P.)**

Title :
LAYOUT PLAN

Subtitle :
EXTERNAL RECYCLE WATER SUPPLY SYSTEM

Drawing Released For :
 APPROVAL
 ADVANCE COPY
 SUBMISSION
 CONSTRUCTION

Drg. No :
MORADABAD/ ES-04

Date :
29 February 2024

Scale :
1:1200

Drawn By :
Amit kumar

Design By :
:

Ckd By :
Anand Havelia

Architects :
Modarchindia
Architects Interior designers & planners
Studio: 1st floor, B-99, sector-63, Noida -201301, U.P.
Phone: 01120 420253,
email: amitgargal@hotmail.com, website: www.modarch.in

Services Consultant :
Consummate Engineering Services (P) Ltd.
Noida Office : B - 67, Sector - 67, Noida - 201 301
Tel : (0120) 2303500 (24 Lines)
Lko. Office : R 006, Rohtas Plumeria, Gomti Nagar, Lucknow
e mail : mail@cespl.in, website : www.cespl.in