

Water Demand	MLD
Potable Water Demand	2.74
Flushing Water Demand	3.28
Fire Water Demand	1.8
Waste Water Generated	5.45
STP	5.99
Recycle Water Generated	4.36
AC Cooling Demand	2.28
Washing & Cleaning	0.45
Horticulture Demand	0.34
Recycle Water Required (including flushing)	6.31
Make-up Water required	1.95
Total Daily Potable Water Requirement	4.69

LEGEND	
	W.S. Network (90 Ø)
	W.S. Network (110 Ø)
	W.S. Network (125 Ø)
	W.S. Network (160 Ø)
	W.S. Network (200 Ø)
	W.S. Network (250 Ø)
	W.S. Network (300 Ø)
	W.S. Network (350 Ø)
	W.S. Network (450 Ø)
	W.S. Network (500 Ø)
	W.S. Network (600 Ø)
	W.S. Node
	Under Ground Water Tank
	Scour Valve
	P-335
	L-1241m
	D-100mm
	J-100
	PSP-3A
	GL-163.890
	DMA Boundary
	7 M Road
	9 M Road
	12 M Road
	18 M Road
	SITE BOUNDARY

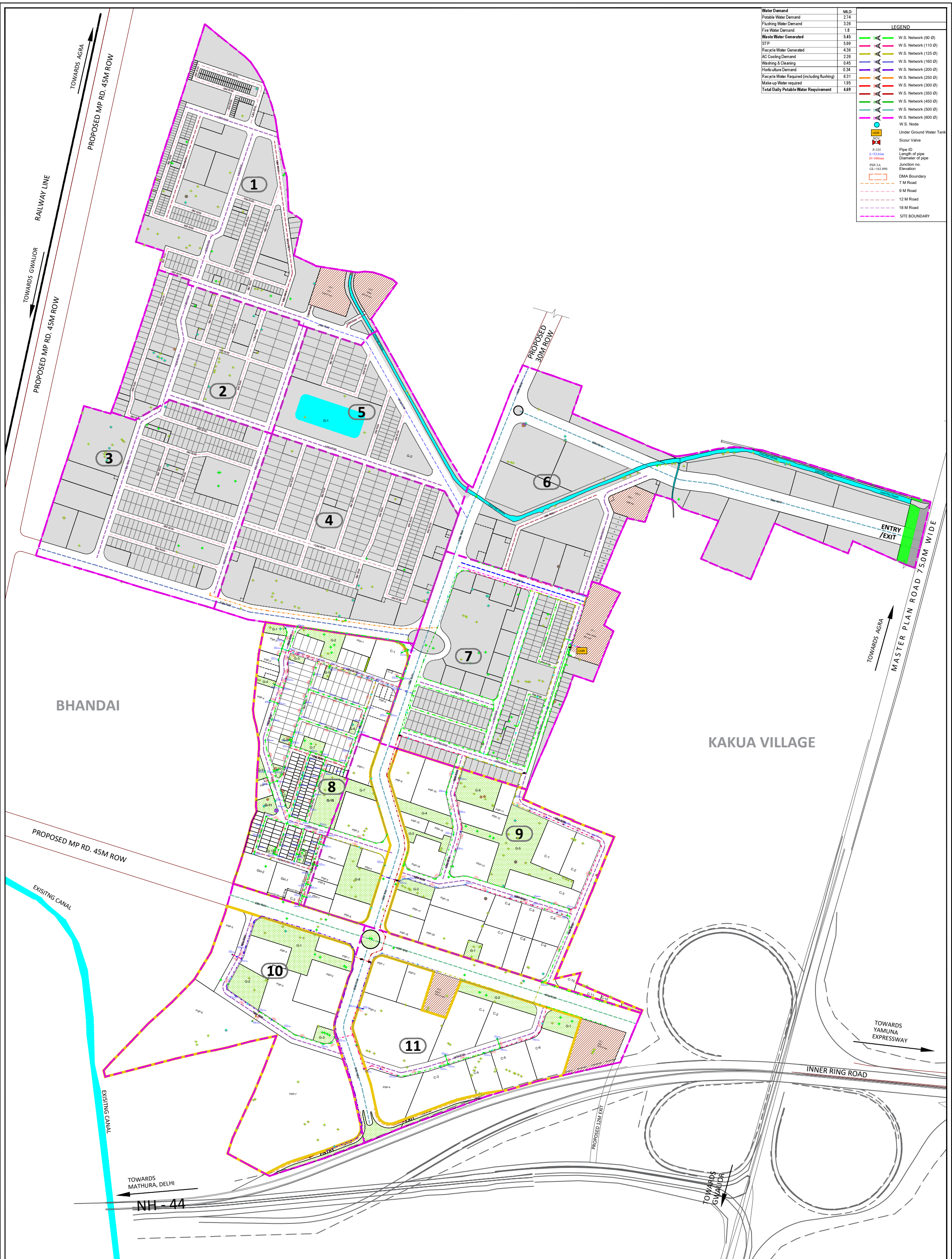

REV.	DATE	DESCRIPTION	CLIENT :	PROJECT TITLE :	DRAWING TITLE :	DRAWING NO :	GRAPHIC SCALE :	ISSUE RECORD	APPROVED FOR ISSUE
3			Agra Development Authority ADA Ratan Muni Rd, Jaipur House, Jaipur House Colony, Agra, Uttar Pradesh 282010	Proposed Layout Plan of Atal Puram Scheme, situated at Kakua & Bhandai Village, Gwalior Road, Agra.	PHASE 3 - POTABLE WATER SUPPLY NETWORK	VSPL/IPD/2324-066/PH3/WS/01		Concept	
2								DRP	
1								Tender	
0								Revision	
REV.	DATE	DESCRIPTION	CONSULTANT: Voyants Solutions Pvt. Ltd. 403, 4th Floor, Park Centra, Sec.-30 NH-8, Gurgaon - 122001, India.					SHEET SIZE A1	Date RD AUG. 25