

PROPOSED AFFORDABLE LAYOUT OF KRISHNA CARNIVAL (AFFORDABLE RESIDENTIAL SCHEME) ON KHASARA NO- 72,74,75 (P) 76,77,78 SITUATED AT MAUZA MEGHTAI SIKANDRA AGRA OWNER :- P G INFRA DEVELOPERS LLP THROUGH SIGNATORY ANURAG AGARWAL

PROPOSED AFFORDABLE LAYOUT OF KRISHNA CARNIVAL (AFFORDABLE RESIDENTIAL SCHEME) ON KHASARA NO- 72,74,75 (P) 76,77,78 SITUATED AT MAUZA MEGHTAI SIKANDRA AGRA OWNER :- P G INFRA DEVELOPERS LLP THROUGH SIGNATORY ANURAG AGARWAL

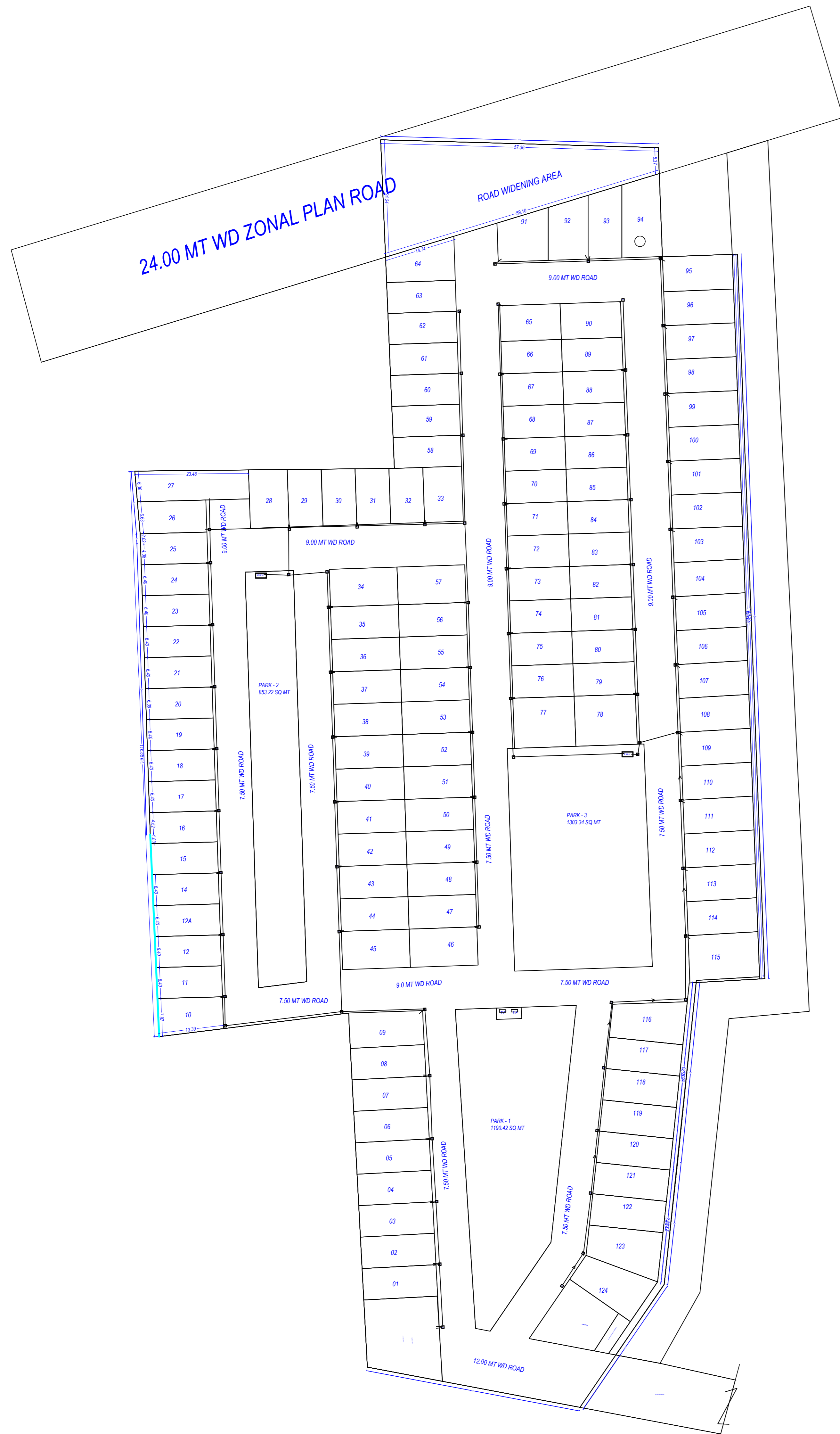

RAINWATER HARVESTING PLAN

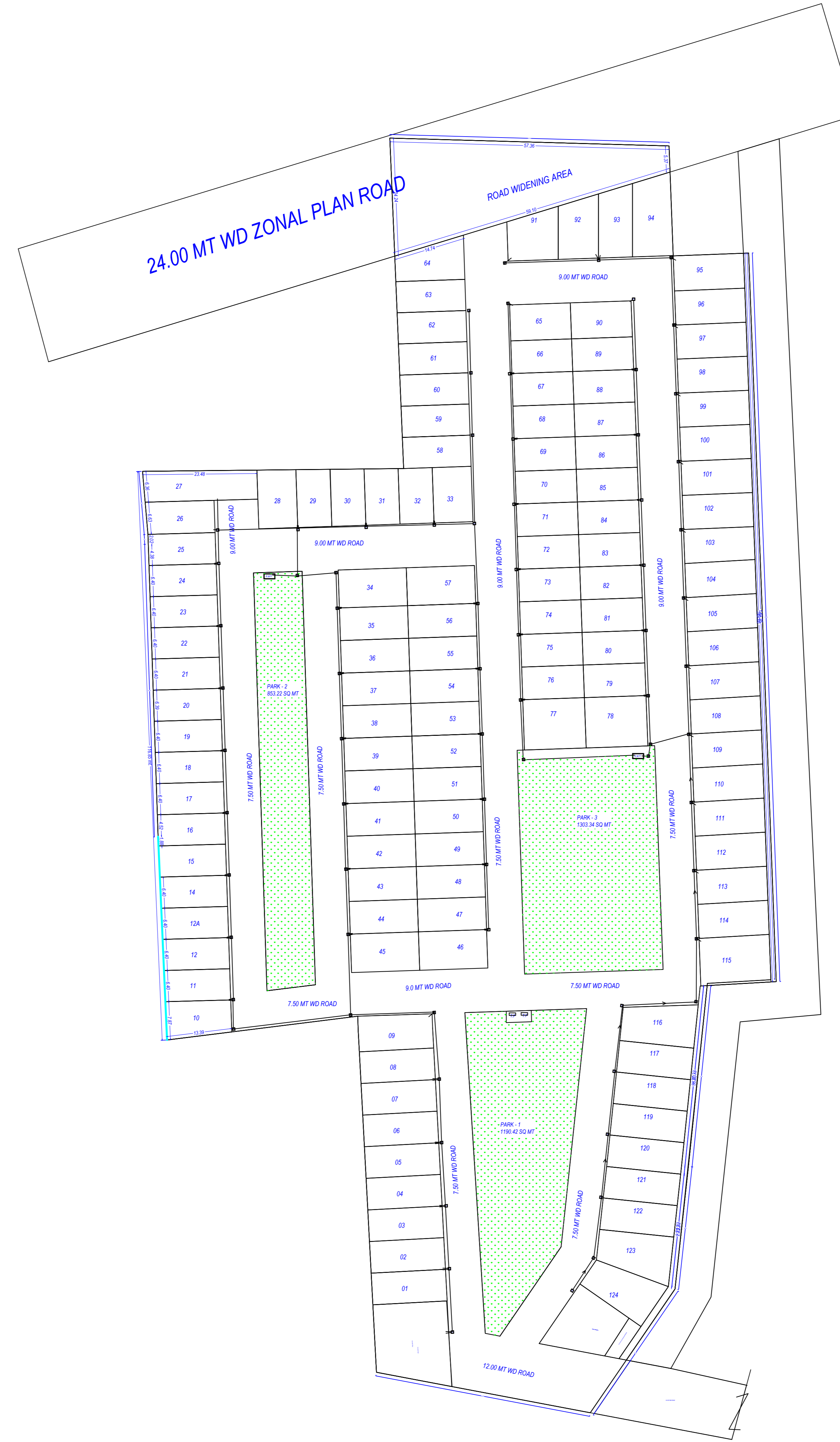

LANDSCAPE , ROAD & WATER LINE PLAN

Note: - 1) This drawing is prepared as per the current prevailing Building Bye Laws.
2) If Map sanctioned is used for purpose anything other than stated in application will lead to rejection of Map.

Total Plot Area: -	22521.49	Total FAR Area: -	0.00
Total Coverage Area: -	0.00	Total BUA Area: -	0.00

OWNER'S NAME AND SIGNATURE
P G INFRA DEVELOPERS LLP THROUGH SIGNATORY ANURAG AGARWAL, anu.ag8@gmail.com, 9897028686

ARCHITECT'S NAME AND SIGNATURE
Vishnu Upadhyay
CA2022148821

Agra Development Authority



Building Plan Application Number

ADALD/23-24/1514

Sanctioned On

24 Dec 2024

Valid Till

01 Jan 2030

Approved By

M. ARUNMOZHI (Vice Chairman)

Examined By

Satendra Solanki (JE)

Satish Chand Rajput (Assistant Engineer)

Probhat Paul (Town Planner)

Probhat Paul (Chief Town Planner)

Shradha Shandilyayan (Secretary)

M. ARUNMOZHI (Vice Chairman)