

SEWAGE LINE 

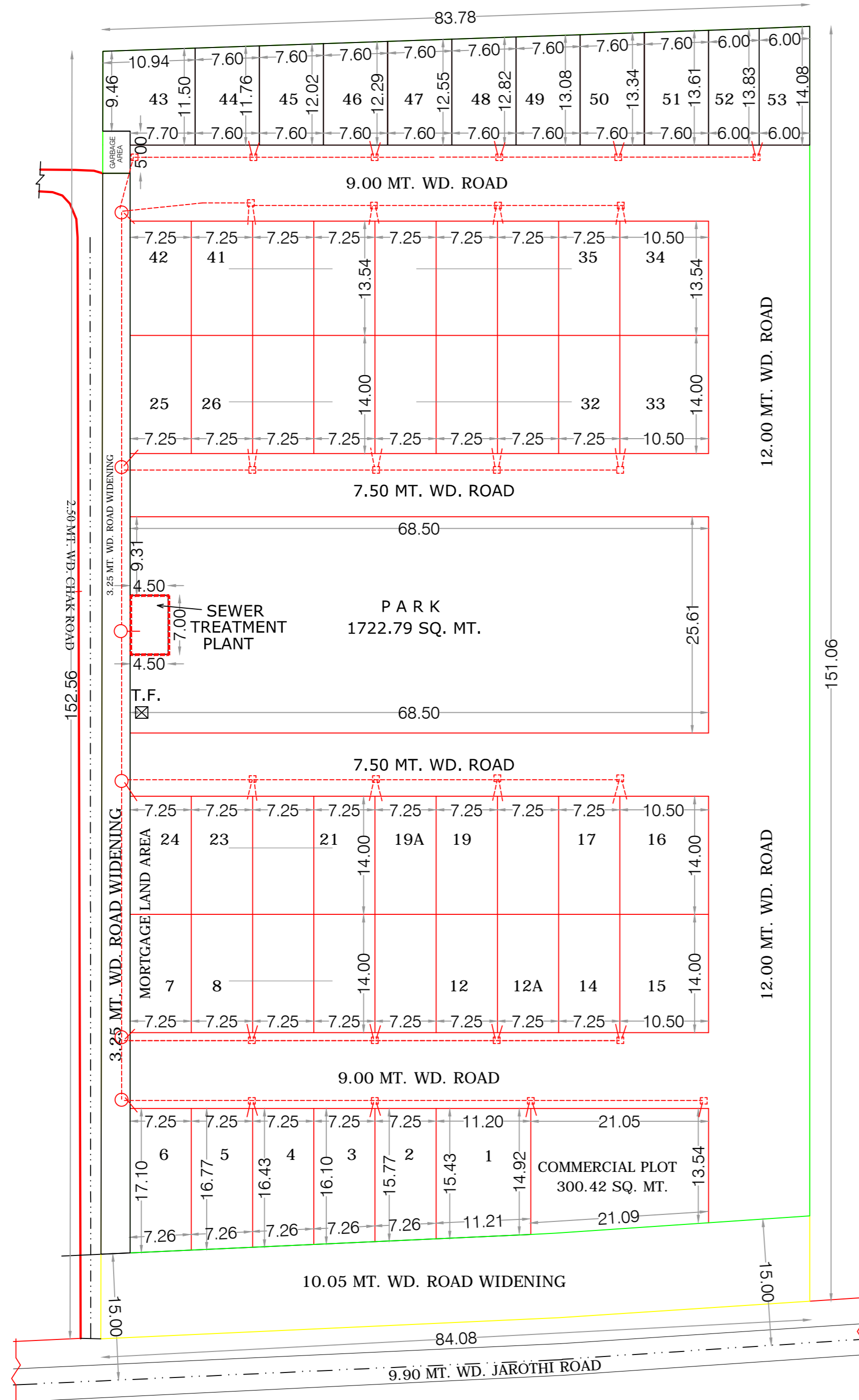

HPDA APPROVED MAP  
 FILE NO. = HPDA/LD/24-25/0205  
 SUBMISSION DATE = 19/10/2024  
 SANCTIONED DATE = 25/02/2025

LAY OUT PLAN OF SUNRISE ESTATE SITUATED AT :- PART OF KHASRA NO. 991, VILLAGE SHAHMAHI-UDDINPUR TEHSIL & DISTT. HAPUR -U.P.  
 OWNER:-  
 MR. SHISH PAL SINGH S/O MR. KHAM CHAND

AREA CHART

1 - TOTAL AREA OF LAND	= 12740.00 SQ. M.
2 - FRONT ROAD WIDENING	= 842.98 SQ. M.
3 - SIDE ROAD WIDENING	= 427.66 SQ. M.
4 - TOTAL ROAD WIDENING AREA	= 1270.64 SQ. M.
5 - NET LAND AREA	= 11469.36 SQ. M.
6 - TOTAL PLOTS AREA	= 5611.60 SQ. M. 48.93 %
7 - COMMERCIAL AREA	= 300.42 SQ. M. 2.62 %
8 - PARK AREA	= 1722.79 SQ. M. 15.02 %
9 - ROAD AREA	= 3786.88 SQ.M. 33.02 %
10- GARBAGE AREA	= 16.17 SQ.M. 0.13 %
11- STP AREA	= 31.50 SQ.M. 0.41 %

SIGN. OF ARCHITECT. :-

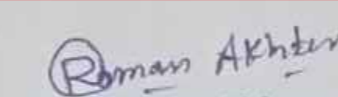
  
 Ar. Roman Akhter  
 B.Arch  
 CA/2017/86745

