

S.NO.	PARTICULARS	AREA (SQ.M)
1	A	4.50
2	X	1.50
3	X	1.50
4	X	1.50
5	X	1.50
6	X	1.50
7	X	1.50
8	X	1.50
9	X	1.50
10	X	1.50
11	X	1.50
12	X	1.50
13	X	1.50
14	X	1.50
15	X	1.50
TOTAL		62.133

S.NO.	PARTICULARS	AREA (SQ.M)
1	A	4.50
2	X	1.50
3	X	1.50
4	X	1.50
5	X	1.50
6	X	1.50
7	X	1.50
8	X	1.50
9	X	1.50
10	X	1.50
11	X	1.50
12	X	1.50
13	X	1.50
14	X	1.50
15	X	1.50
TOTAL		62.133

S.NO.	PARTICULARS	AREA (SQ.M)
1	A	4.50
2	X	1.50
3	X	1.50
4	X	1.50
5	X	1.50
6	X	1.50
7	X	1.50
8	X	1.50
9	X	1.50
10	X	1.50
11	X	1.50
12	X	1.50
13	X	1.50
14	X	1.50
15	X	1.50
TOTAL		62.133

S.NO.	TYPE	WIDTH	DEPTH	CL.	UNIT	REMARKS
1	DN	125	200	0	200	KITCHEN
2	DN	125	200	0	200	BED ROOM
3	DN	125	200	0	200	BED ROOM
4	DN	125	200	0	200	BED ROOM
5	DN	125	200	0	200	BED ROOM
6	DN	125	200	0	200	BED ROOM
7	DN	125	200	0	200	BED ROOM
8	DN	125	200	0	200	BED ROOM
9	DN	125	200	0	200	BED ROOM
10	DN	125	200	0	200	BED ROOM
11	DN	125	200	0	200	BED ROOM
12	DN	125	200	0	200	BED ROOM
13	DN	125	200	0	200	BED ROOM
14	DN	125	200	0	200	BED ROOM
15	DN	125	200	0	200	BED ROOM

SYMBOL	DESCRIPTION
[Pattern]	FAR AREA
[Pattern]	COUNTED IN 15% ADDITIONAL FAR AREA
[Pattern]	NON FAR AREA

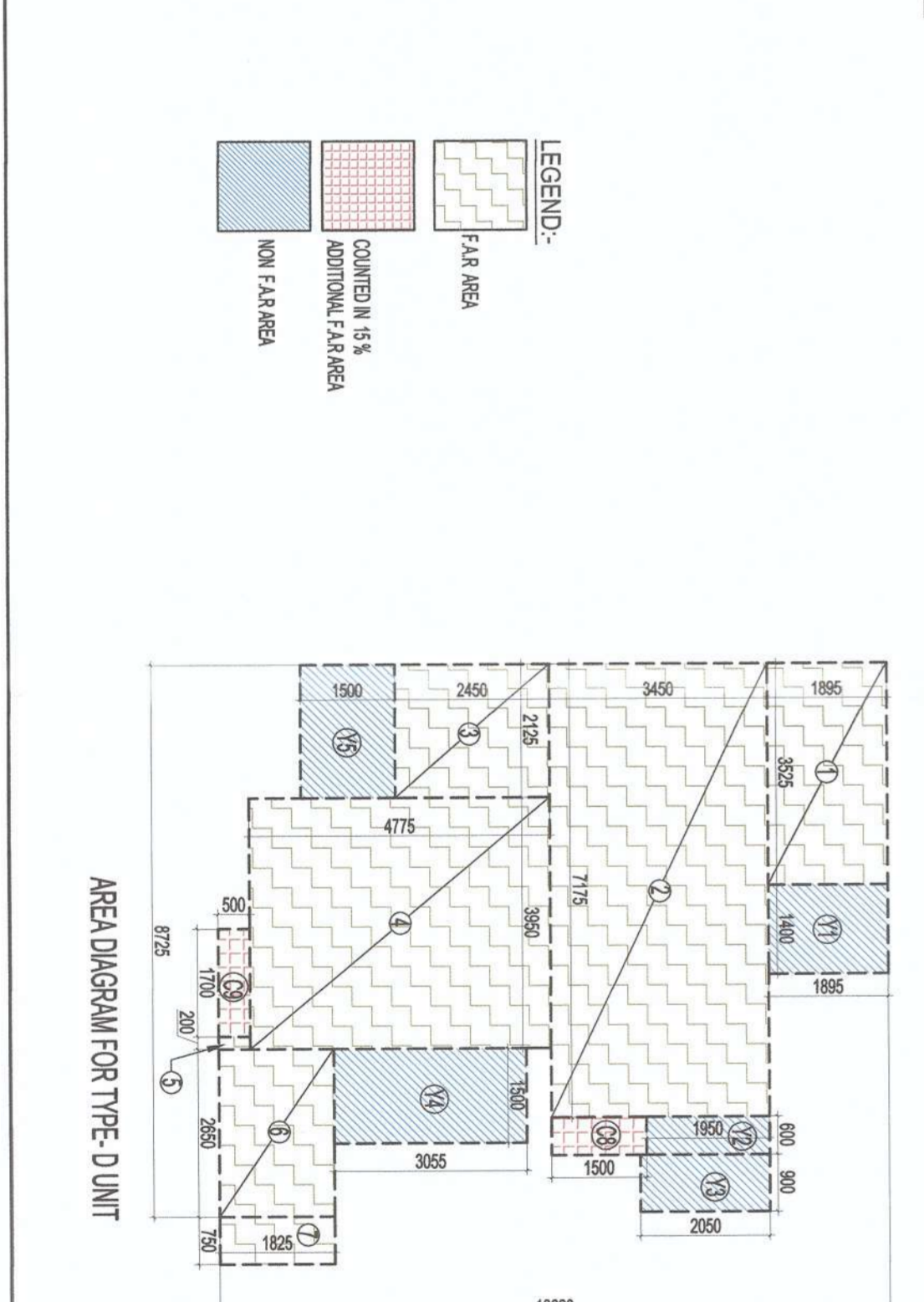

S.NO.	PARTICULARS	AREA (SQ.M)
1	COVERED AREA OF UNIT	5.820
2	X	2.180
3	X	0.820
4	X	1.150
5	X	0.220
6	X	4.144
7	X	19.305
8	X	22.819
9	X	0.070
TOTAL AREA (A)		65.502

S.NO.	PARTICULARS	AREA (SQ.M)
1	COVERED AREA OF UNIT	2.775
2	X	2.835
3	X	12.715
4	X	0.100
5	X	4.850
6	X	12.950
TOTAL AREA (B)		58.878

S.NO.	PARTICULARS	AREA (SQ.M)
1	COVERED AREA OF UNIT	6.880
2	X	24.754
3	X	5.285
4	X	18.881
5	X	0.100
6	X	4.835
7	X	3.188
TOTAL AREA (C)		60.437

S.NO.	PARTICULARS	AREA (SQ.M)
1	COVERED AREA OF UNIT	6.880
2	X	24.754
3	X	5.285
4	X	18.881
5	X	0.100
6	X	4.835
7	X	3.188
TOTAL AREA (D)		61.806

S.NO.	PARTICULARS	AREA (SQ.M)
1	FAR AREA OF UNIT - A	58.878
2	FAR AREA OF UNIT - B	60.437
3	FAR AREA OF UNIT - C	61.806
4	FAR AREA OF UNIT - D	59.133
TOTAL FAR AREA		240.254

S.NO.	PARTICULARS	AREA (SQ.M)
1	FAR AREA OF UNIT - A	117.756
2	FAR AREA OF UNIT - B	181.311
3	FAR AREA OF UNIT - C	61.806
4	FAR AREA OF UNIT - D	1.200
TOTAL FAR AREA		462.073

UNIT - A	UNIT - B	UNIT - C	UNIT - D	
19.306	13.393	13.438	13.438	
X	X	X	X	
2	2	3	1	
38.732	26.786	40.314	13.438	
TOTAL AREA				118.270

S.NO.	PARTICULARS	AREA (SQ.M)
1	FAR AREA OF UNIT - A	58.878
2	FAR AREA OF UNIT - B	60.437
3	FAR AREA OF UNIT - C	61.806
4	FAR AREA OF UNIT - D	1.200
TOTAL FAR AREA		182.321

S.NO.	PARTICULARS	AREA (SQ.M)
1	FAR AREA OF UNIT - A	58.878
2	FAR AREA OF UNIT - B	60.437
3	FAR AREA OF UNIT - C	61.806
4	FAR AREA OF UNIT - D	1.200
TOTAL FAR AREA		182.321

S.NO.	PARTICULARS	AREA (SQ.M)
1	FAR AREA OF UNIT - A	58.878
2	FAR AREA OF UNIT - B	60.437
3	FAR AREA OF UNIT - C	61.806
4	FAR AREA OF UNIT - D	1.200
TOTAL FAR AREA		182.321

S.NO.	PARTICULARS	AREA (SQ.M)
1	FAR AREA OF UNIT - A	58.878
2	FAR AREA OF UNIT - B	60.437
3	FAR AREA OF UNIT - C	61.806
4	FAR AREA OF UNIT - D	1.200
TOTAL FAR AREA		182.321

S.NO.	PARTICULARS	AREA (SQ.M)
1	FAR AREA OF UNIT - A	58.878
2	FAR AREA OF UNIT - B	60.437
3	FAR AREA OF UNIT - C	61.806
4	FAR AREA OF UNIT - D	1.200
TOTAL FAR AREA		182.321

S.NO.	PARTICULARS	AREA (SQ.M)
1	FAR AREA OF UNIT - A	58.878
2	FAR AREA OF UNIT - B	60.437
3	FAR AREA OF UNIT - C	61.806
4	FAR AREA OF UNIT - D	1.200
TOTAL FAR AREA		182.321

S.NO.	PARTICULARS	AREA (SQ.M)
1	FAR AREA OF UNIT - A	58.878
2	FAR AREA OF UNIT - B	60.437
3	FAR AREA OF UNIT - C	61.806
4	FAR AREA OF UNIT - D	1.200
TOTAL FAR AREA		182.321

S.NO.	PARTICULARS	AREA (SQ.M)
1	FAR AREA OF UNIT - A	58.878
2	FAR AREA OF UNIT - B	60.437
3	FAR AREA OF UNIT - C	61.806
4	FAR AREA OF UNIT - D	1.200
TOTAL FAR AREA		182.321

PROPOSED GROUP HOUSING FOR DECENT BUILDWELL PVT. LTD. AT PLOT NO. - GH-05A SECTOR- 16B, GREATER NOIDA (UP)
 PROJECT: TOWER - FONTANE
 DATE: 07-06-16
 SCALE: 1:1000
 DRAWING TITLE: FIRST, SECOND & THIRD FLOOR PLAN
 ARCHITECTS: DEVESH SHARMA, VISHAL SHARMA
 CHECKED BY: DEVESH SHARMA
 DRAWING NO.: S-37
 REVISION:

OWNER: M/S DECENT BUILDWELL PVT. LTD.
 ARCHITECT SIGN: [Signature]
 SUBMISSION DRAWING
 TOWER - FONTANE
 DECENT BUILDWELL PVT. LTD.
 GH-05A SECTOR- 16B, GREATER NOIDA (UP)

APPROVED
 Date: 23/12/2016
 M/S DECENT BUILDWELL PVT. LTD.
 GH-05A SECTOR- 16B, GREATER NOIDA (UP)

Greater Noida (including De- A-3) City
 APPROVED
 Date: 23/12/2016
 M/S DECENT BUILDWELL PVT. LTD.
 GH-05A SECTOR- 16B, GREATER NOIDA (UP)

APPROVED
 Date: 23/12/2016
 M/S DECENT BUILDWELL PVT. LTD.
 GH-05A SECTOR- 16B, GREATER NOIDA (UP)