

GOVINDPURAM HOUSING SCHEME (गोविन्दपुरम आवासीय योजना)
 at Village Mangupura khasra Nos. 642, 647, 648मि०, 649मि०, 650/1, 650/2, 651, 652, 653अ, 653ब, 654, 655, 656मि०, 658, 659, 669मि०, 669मि०, 672मि०, 672, 673, 674, 675, 676, 677, 678क, 678म, 679, 680क, 680ग, 681, 682, 683, 684, 685, 686, 687, 688, 689, 690, 691, 692, 693, 694, 696, 697ख, 697, 697मि०, 698, 699, 700, 701, 702, 703, 643, 644 and Village Manoharpur khasra Nos. 123, 124, 125, 127, 128, 149, 150, 151, 162, 168, 175, 176, 177, 178, 179, 180, 181, 182, 183, 184, 191, 192, 195, 196, 231, 234, 235, 236, 237, 238, 240, 241, 242, 243, 244, 245, 248, 259, 260, 261, 262, 263, 280, 282, 283, 287, 288, 197क, 197ख, 197ग, 197घ, 197ङ, 197ड, 290क, 290ख, 290ग, 290घ, 290च, 290ज, 290झ, 290ञ, 259/1303, 281, 126, 165, 239, 264

LEGEND	
	GARBAGE COLLECTION CENTRE (GCC)

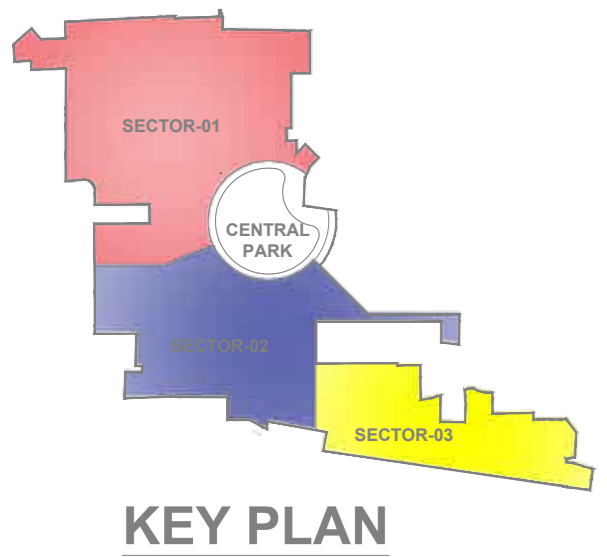

WASTE DISPOSAL PLAN

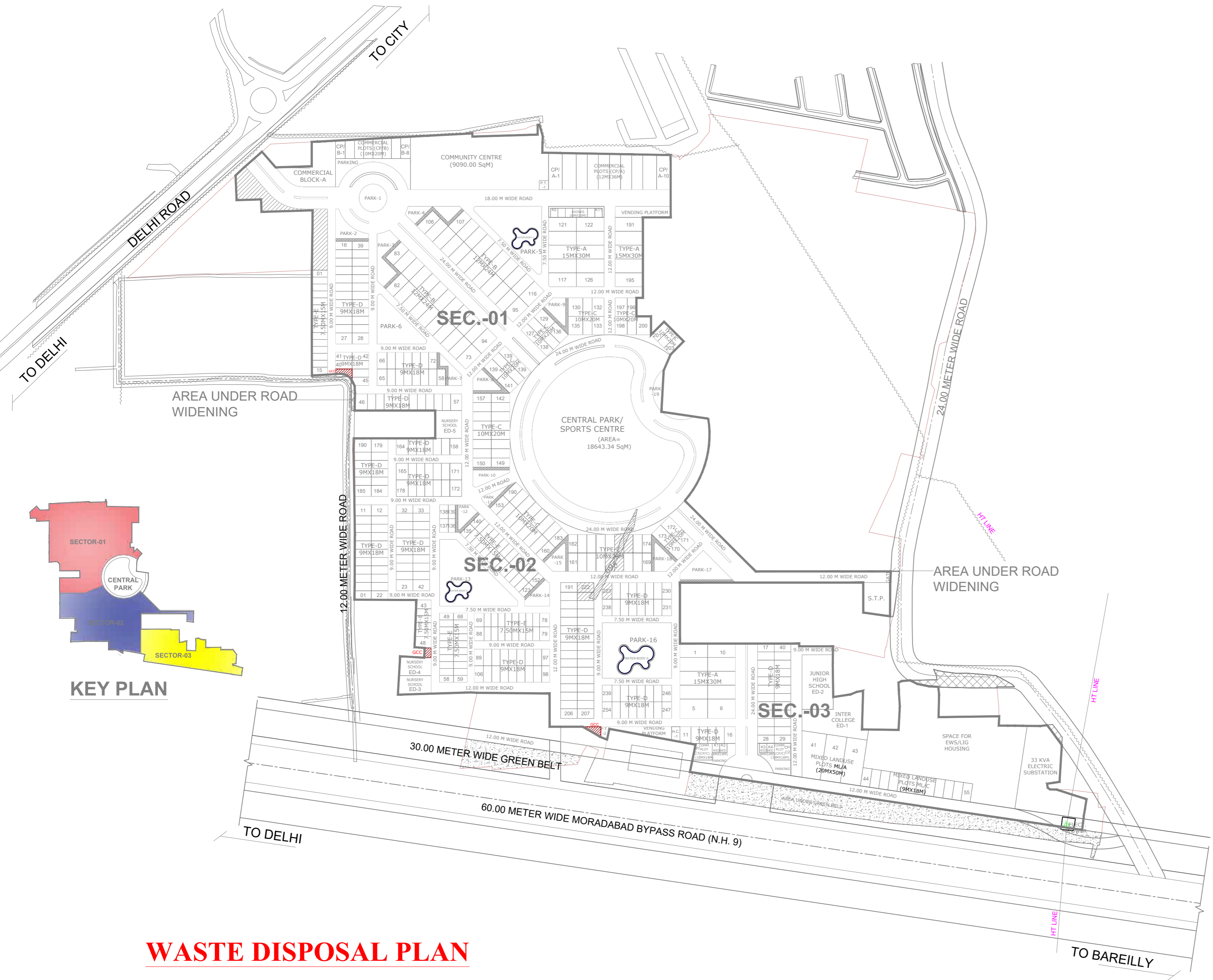

**MORADABAD DEVELOPMENT AUTHORITY,
MORADABAD**

**LAYOUT OF GOVINDPURAM HOUSING SCHEME
(गोविन्दपुरम आवासीय योजना) PHASE-1 AT VILLAGE
MANGUPURA & MANOHARPUR, MORADABAD (U.P.)**

Note:

- The setbacks and ground coverage are as per building bye-laws.
- The existing chak roads have been merged in proposed road network as much as possible.
- In this drawing it is considered that existing 11/33 kv electric lines (H/T transmission) are are relocated or laid underground.
- The minimum requirement of social infra as per by-laws has been planned considering total land acquisition.
- PLOT sizes mentioned in drawings are standard sizes except corner plots, which will be measured as per site.
- In execution the area/ dimensions may deviate at site.
- The services of this scheme are to be linked/ incorporated with the existing/ proposed services of the surrounding area.

Ar. Sumit Agarwal
CA/1999/24025

ARCON
Shri KAILASHAM, 714, JANAKPURI,
Bareilly 243122
Mob: 9837095138
email: sumit.architects@gmail.com
sumit.architects@yahoo.com

DIRECTION

1:1500
SCALE

28-10-2025
DATE

GOVINDPURAM HOUSING SCHEME (गोविन्दपुरम आवासीय योजना) at Village Mangupura khasra Nos. 642, 647, 648मि०, 649मि०, 650/1, 650/2, 651, 652, 653अं, 653बं, 654, 655, 656मि०, 658, 659, 669मि०, 669मि०, 672मि०, 672, 673, 674, 675, 676, 677, 678कं, 678सं, 679, 680कं, 680गं, 681, 682, 683, 684, 685, 686, 687, 688, 689, 690, 691, 692, 693, 694, 696, 697खं, 697, 697मि०, 698, 699, 700, 701, 702, 703, 643, 644 and Village Manoharpur khasra Nos. 123, 124, 125, 127, 128, 149, 150, 151, 162, 168, 175, 176, 177, 178, 179, 180, 181, 182, 183, 184, 191, 192, 195, 196, 231, 234, 235, 236, 237, 238, 240, 241, 242, 243, 244, 245, 248, 259, 260, 261, 262, 263, 280, 282, 283, 287, 288, 197कं, 197खं, 197गं, 197घं, 197चं, 197डं, 290कं, 290खं, 290गं, 290घं, 290चं, 290छं, 290डं, 259/1303, 281, 126, 165, 239, 264

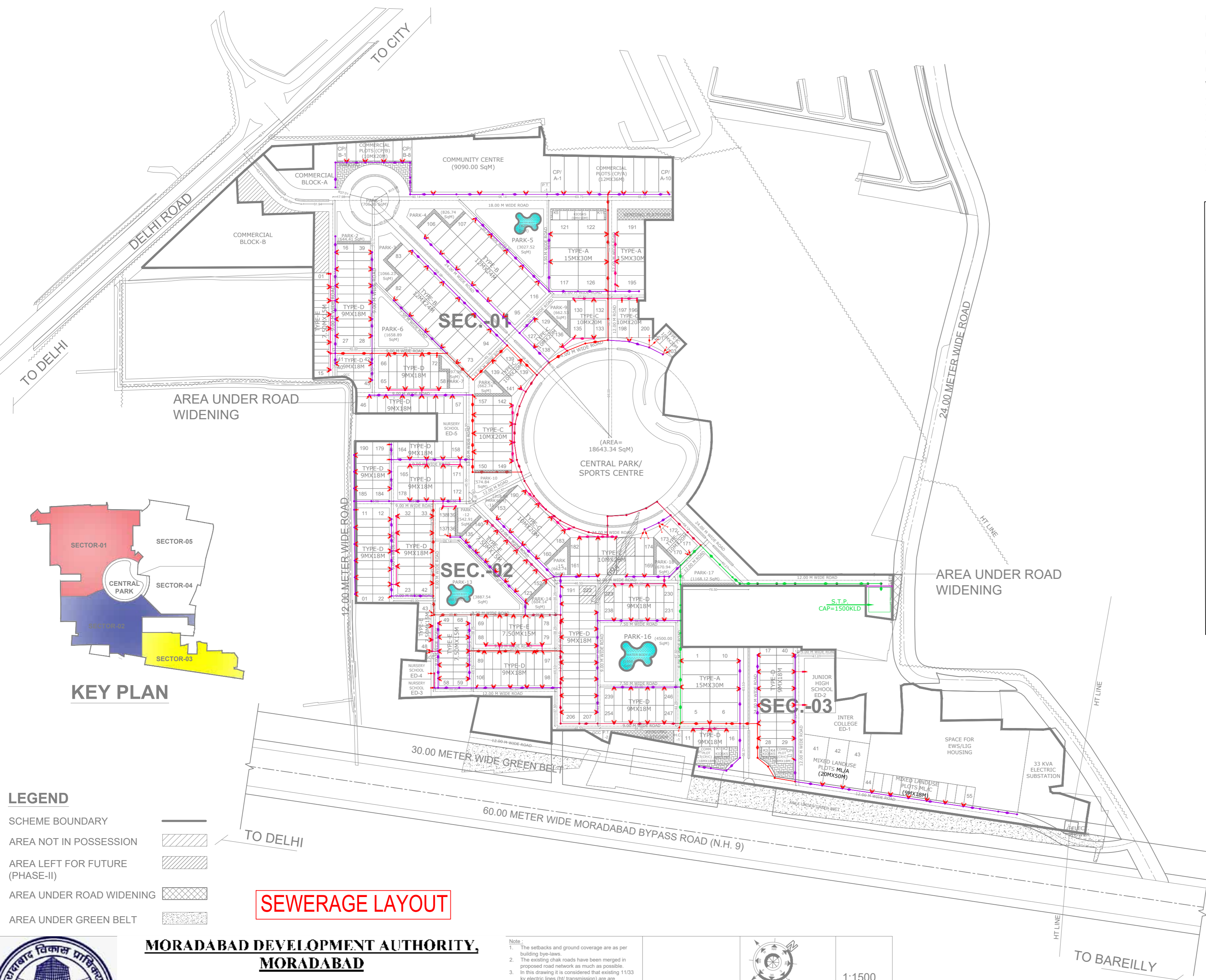

EXTERNAL SEWERAGE LEGEND:-	
	2000 NP2 RCC SEWERAGE PIPE, SLOPE=1:250
	2000 NP2 RCC SEWERAGE PIPE, SLOPE=1:250
	2500 NP2 RCC SEWERAGE PIPE, SLOPE=1:300
	3000 NP2 RCCSEWERAGE PIPE, SLOPE=1:600
	4500 NP2 RCCSEWERAGE PIPE, SLOPE=1:700
	900X800MM SEWERAGE MANHOLE FOR 2000 NP2 RCC SEWERAGE PIPE.
	900MM DIA SEWERAGE MANHOLE FOR 2000 TO 2500 NP2 RCC SEWERAGE PIPE.
	1200MM DIA SEWERAGE MANHOLE FOR 2500 TO 3000 NP2 RCC SEWERAGE PIPE.
	1500MM DIA SEWERAGE MANHOLE FOR 4500 NP2 RCC SEWERAGE PIPE.
G.L	GROUND LEVEL
I.L	INVERT LEVEL
C.L	CONNECTION LEVEL

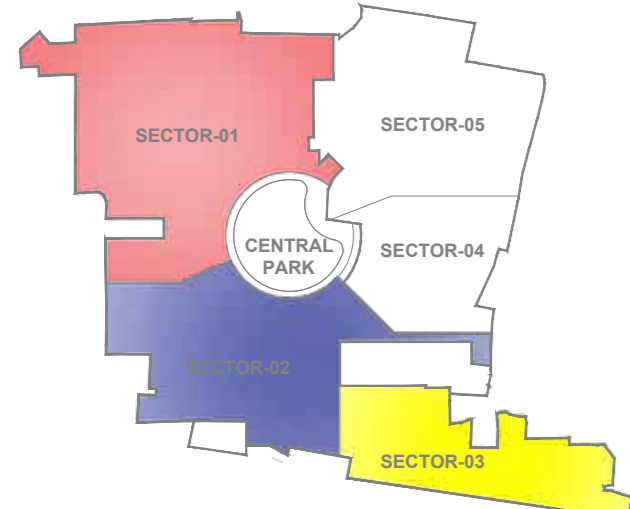

LEGEND	
SCHEME BOUNDARY	
AREA NOT IN POSSESSION	
AREA LEFT FOR FUTURE (PHASE-II)	
AREA UNDER ROAD WIDENING	
AREA UNDER GREEN BELT	

SEWERAGE LAYOUT



MORADABAD DEVELOPMENT AUTHORITY, MORADABAD
LAYOUT OF GOVINDPURAM HOUSING SCHEME (गोविन्दपुरम आवासीय योजना) PHASE-1 AT VILLAGE MANGUPURA & MANOHARPUR, MORADABAD (U.P.)

Note:
 1. The setbacks and ground coverage are as per building bye-laws.
 2. The existing chak roads have been merged in proposed road network as much as possible.
 3. In this drawing it is considered that existing 11/33 kv electric lines (H/T transmission) are relocated or laid underground.
 4. The minimum requirement of social infra as per by-laws has been planned considering total land acquisition.
 5. Plot sizes mentioned in drawings are standard sizes except corner plots, which will be measured as per site.
 6. In execution the area/ dimensions may deviate at site.
 7. The services of this scheme are to be linked/ incorporated with the existing/ proposed services of the surrounding area.

Ar. Sumit Agarwal CA/1999/24025		DIRECTION	1:1500 SCALE
ARCON Shri KAILASHAM, 714, JANAKPURI, Bareilly 243122 Mob: 9837095138 email: sumit.architects@gmail.com sumit.architects@yahoo.com	27.11.2025 DATE		