

PROJECT
ITHUM 62
(PROPOSED I.T & I.TES
DEVELOPMENT
FOR SBTL GROUP)

PROJECT ADDRESS:
INDUSTRIAL AREA
SECTOR 62, NOIDA

PROJECT NO.:
128

NOTES:
THIS DRAWING IS A BONAFIDE PROPERTY OF THE ARCHITECT
M/S ATWIN & IS NOT TO BE COPIED OR REPRODUCED WITHOUT
PRIOR CONCERN
ALL DIMENSIONS ARE TO BE REFERRED & NOT BE MEASURED ON
ANY DISCREPANCIES SHALL BE BROUGHT TO ENGINEERS
ATTENTION PRIOR COMMENCEMENT OF WORK. FAILURE TO
COMPLY WITH THE ABOVE WILL BE CONTRACTORS LIABILITY
SOFTWARE USED: AUTOCAD
KEY PLAN:

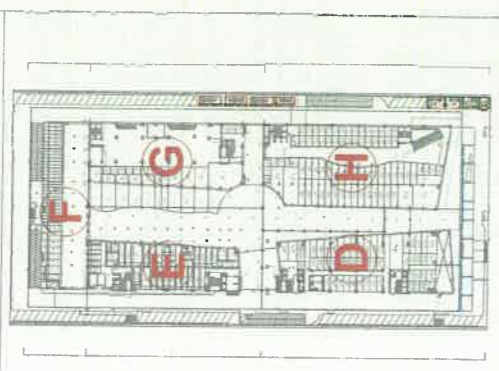

LEGEND : LINES

S.NO	LINE TYPE	DESCRIPTION
01	PLOT LINE	
02	SETBACK LINE	
03	BLOCK LINE EXPANSION (JOINT FLOOR LEVEL)	
04	BASEMENT LINE	

LEGEND : GRID LINES

S.NO	GRID LINE	TOWER NAME
01	UNIVERSAL GRIDS	
02	TOWER D	
03	TOWER E	
04	TOWER F	
05	TOWER G	
06	TOWER H	

LEGEND : RETAINING WALL HATCH

S.NO	DESCRIPTION	HATCHLINE
01	EXISTING RETAINING WALL	
02	PROPOSED RETAINING WALL	

LEGEND : SUNK HATCH

1	100 MM SUNK TOILET
---	-----------------------

Digitally signed
by Ateesh
Agarwal
Date: 2026.04.26
16:19:13 +05'30'

ATWIN
ARCHITECTS

BRU (INDIA) ARCHITECTS
F-89, GREEN PARK, NEW DELHI -16.
Ph. +91-11-26863815, 26863837
Fax: +91-11-26850788
E-mail: bruch[atwin@gmail.com
Website: www.atwin.in

SOFTWARE PRIVATE LIMITED
NOIDA

VINECH
CONSULTANTS
ENGINEERS
& PROJECT MANAGERS

STRUCTURAL CONSULTANT

B-50, Basement, Soami Nagar
New Delhi-110017
Tel No: 011-49848197 & 49849205
Email: info@vconconsulting.co.in

**MASTER LAYOUT
(GROUND FLOOR PLAN)
+900 (TOS)**

SCALE: RELEASED FOR:
NAME: SIGN: DATE: CONCEPT
APPD: ATEESH: GEN. ARNT: TENDER
CHKD: K.R: TENDER
DRAWN: SHAAN: 20-01-23
IT-B2/MASTER LAYOUT/GF
DATE (ISSUE DATE): 2023-02-16

